

PUNTO L

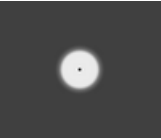

LF8019.698-EN-S-700-740

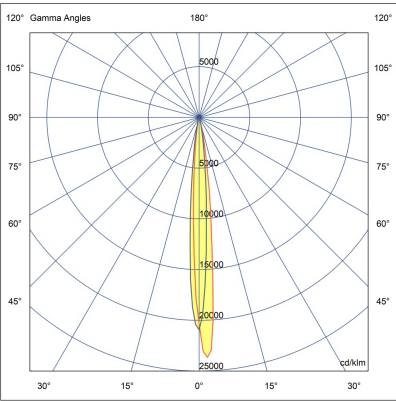
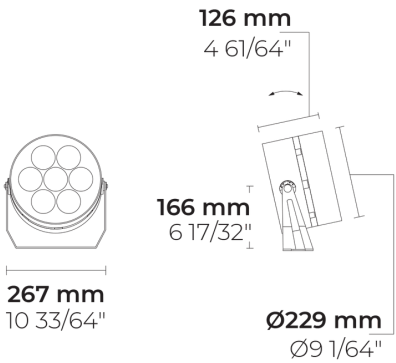

[S]

Spot - NEMA Type 0

Configuration

Light distribution	[S] 7°
Delivered lumens flux	7060 lm
Rated input power	60 W
Color temperature	4000 K CRI 70
Luminaire efficacy	121 lm/W
Lamp	7 LED
Color Deviation	5 SDCM
Lifetime L90 (hour)	>72,600
Lifetime L80 (hour)	>72,600

Options

Technical information

Mounting	Yoke mount (standard), stake mount (optional)
Tilt angle	+60°/-30°
Housing	Corrosion resistant, die-cast, marine grade aluminum housing
Finishing	Chromate conversion pretreatment followed by electrostatic powder coating
Fasteners	Stainless steel (AISI 304 / EN 1.4301 grade)
Gasket	Silicone rubber
Lens / Reflector	High reflectance aluminium coating [S] [N], PMMA lens with high optical efficiency [MN] [M]
Glass / Diffusor	Tempered safety glass
Impact protection	IK08
Ingress protection	IP65
Input voltage	220-240V 50/60Hz
Insulation class	Class I
Wind catching area (EPA)	0.03 m ²
Weight	6.56 kg
LED module	Multi-chip high power LEDs on metal-core PCB
Driver	Internal LED driver
Driver surge protection	8/6 kV
Power factor	> 0.98
Through wiring	Single power cord entry
Operating temperature	-40...50°C
Power cord	16" of flexible power cord

Accessories (To be ordered separately)

Optical accessories

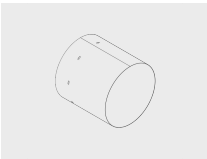

Snoot for PUNTO L

007502177

Mounting accessories



Spike

160405040

Project name				Type		Quantity	
Date		Note					
LF8019.698-EN-S-700-740-__-__-__-__							

Light distribution	Rated input power	Color temperature	Control	Product colors
[S] Spot - NEMA Type 0 - 7° [N] Narrow - NEMA Type 2 - 26° [MN] Medium narrow - NEMA Type 3 - 42° [M] Medium - NEMA Type 4 - 60°	[700] 60 W	[740] 4000 K CRI 70 [827] 2700 K CRI 80 [830] 3000 K CRI 80 [840] 4000 K CRI 80	[ONOFF] On/Off [DALI] DALI	[HM1] Black [HM2] Dark gray [HM3] Anthracite gray [HM4] Light gray [HM5] White [HM6] Bronze [CC] Custom color (Please specify RAL code)
Extras	Accessories (<i>To be ordered separately</i>)			
Consult the factory	Optical accessories			
[UNI] 120-277V 50/60Hz	[007502177] Snoot for PUNTO L			
Luminaire body options	Mounting accessories			
[DPC] Double powder coating	[160405040] Spike			