

PUNTO S Ex

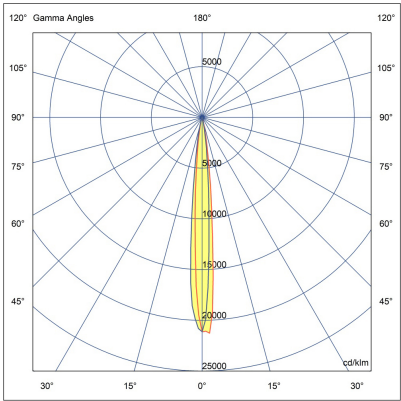

LF8030.693-US-S-700-740

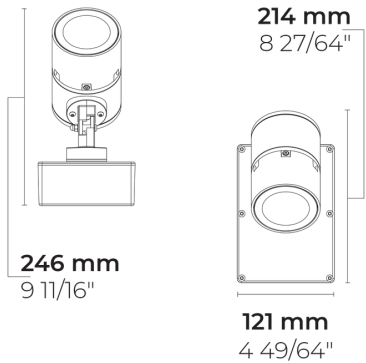

[S]

Spot - NEMA Type 0

Configuration

Light distribution	[S] 7°
Delivered lumens flux	1019 lm
Rated input power	10 W
Color temperature	4000 K CRI 70
Luminaire efficacy	101 lm/W
Lamp	1 LED
Color Deviation	5 SDCM
Lifetime L90 (hour)	>72,600
Lifetime L80 (hour)	>72,600

Options

Technical information

Mounting	Pedestal knuckle mount
Tilt angle	+60°/-30°
Housing	Corrosion resistant, die-cast, marine grade aluminum housing
Finishing	Chromate conversion pretreatment followed by electrostatic powder coating
Fasteners	Stainless steel (AISI 304 / EN 1.4301 grade)
Gasket	Silicone rubber
Lens / Reflector	High reflectance aluminium coating [S] [N], PMMA lens with high optical efficiency [MN] [M]
Glass / Diffusor	Tempered safety glass
Impact protection	IK08
Ingress protection	IP65
Input voltage	120-277V 50/60Hz
Insulation class	Class I
Weight	3 lbs
LED module	Multi-chip high power LEDs on metal-core PCB
Driver	Internal LED driver
Driver surge protection	1/1 kV
Power factor	> 0.90
Through wiring	Single power cord entry
Power cord	16" of flexible power cord

Accessories (To be ordered separately)

Optical accessories

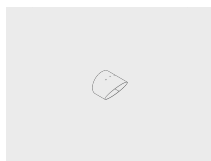

Visor for PUNTO S

007502282

Project name				Type		Quantity	
Date		Note					

LF8030.693-US-S-700-740-

Light distribution	Rated input power	Color temperature	Control	Product colors
<div>[S] Spot - NEMA Type 0 - 7°</div> <div>[N] Narrow - NEMA Type 2 - 26°</div> <div>[MN] Medium narrow - NEMA Type 3 - 42°</div> <div>[M] Medium - NEMA Type 4 - 60°</div>	<div>[700] 10 W</div>	<div>[740] 4000 K CRI 70</div> <div>[827] 2700 K CRI 80</div> <div>[830] 3000 K CRI 80</div> <div>[840] 4000 K CRI 80</div>	<div>[ONOFF] On/Off</div> <div>[0-10V] 0-10V</div>	<div>[HM1] Black</div> <div>[HM2] Dark gray</div> <div>[HM3] Anthracite gray</div> <div>[HM4] Light gray</div> <div>[HM5] White</div> <div>[HM6] Bronze</div> <div>[CC] Custom color (Please specify RAL code)</div>
Extras	Accessories (<i>To be ordered separately</i>)			
Luminaire body options	Optical accessories			
[DPC] Double powder coating	[007502282] Visor for PUNTO S			