

PUNTO S W

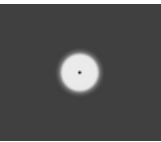

LW8017.693-EN-S-700-840

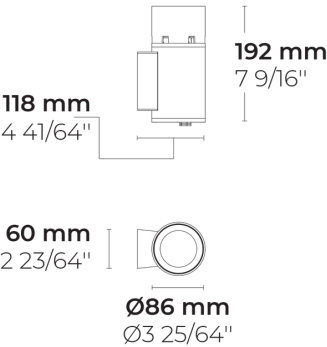

[S]

Spot - NEMA Type 0

Configuration

Light distribution	[S] 7°
Delivered lumens flux	953 lm
Rated input power	10 W
Color temperature	4000 K CRI 80
Luminaire efficacy	91 lm/W
Lamp	1 LED
Color Deviation	5 SDCM
BUG rating	B1-U0-G0
Lifetime L90 (hour)	>72,600
Lifetime L80 (hour)	>72,600

Options

Technical information

Mounting	Wall mountable
Housing	Corrosion resistant, marine grade aluminum housing
Finishing	Chromate conversion pretreatment followed by electrostatic powder coating
Fasteners	Stainless steel (AISI 304 / EN 1.4301 grade)
Gasket	Silicone rubber
Lens / Reflector	High reflectance aluminium coating [S] [N], PMMA lens with high optical efficiency [MN] [M]
Glass / Diffuser	Tempered safety glass
Impact protection	IK08
Ingress protection	IP65
Input voltage	220-240V 50/60Hz
Insulation class	Class I
Weight	1.27 kg
LED module	Multi-chip high power LEDs on metal-core PCB
Driver	Internal LED driver
Driver surge protection	1/1 kV
Power factor	> 0.91
Through wiring	Single power cord entry
Operating temperature	-25...50°C
Power cord	8" of flexible power cord

Accessories (To be ordered separately)



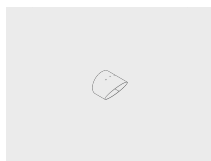



Optical accessories

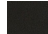

Visor for PUNTO S

007502282

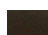
Project name					Type		Quantity	
Date		Note						
LW8017.693-EN-S-700-840-__ - __ - __								

Light distribution	Rated input power	Color temperature	Control	Product colors
[S] Spot - NEMA Type 0 - 7° [N] Narrow - NEMA Type 2 - 26° [MN] Medium narrow - NEMA Type 3 - 42° [M] Medium - NEMA Type 4 - 60°	[700] 10 W	[840] 4000 K CRI 80 [827] 2700 K CRI 80 [830] 3000 K CRI 80 [740] 4000 K CRI 70	[ONOFF] On/Off [DALI] DALI	[HM1]  Black [HM2]  Dark gray [HM3]  Anthracite gray [HM4]  Light gray [HM5]  White [HM6]  Bronze [CC]  Custom color (Please specify RAL code)
Extras	Accessories (<i>To be ordered separately</i>)			
Consult the factory	Optical accessories			
[UNI] 120-277V 50/60Hz	[007502282] Visor for PUNTO S			