

LR9016.521-EN-WW-350-840-ONOFF-EN-C1-SS

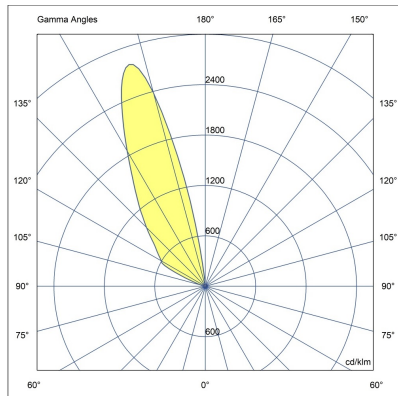
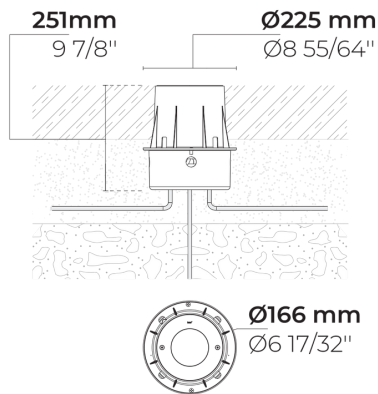

[WW]
Wall-wash

Variant

Light distribution	[WW] 46x25°
Delivered lumens flux	326 lm
Rated input power	4 W
Colour temperature	4000 K CRI 80
Luminaire efficacy	81 lm/W
Lamp	1 LED
MacAdam Ellipse	3 SDCM
Lifetime L90B50 (hour)	>42,000
Lifetime L80B50 (hour)	>42,000

Options

Technical information

Mounting	Ground recessed mountable
Housing	Corrosion resistant stainless steel housing (AISI 316L / EN 1.4571 grade)
Fasteners	Stainless steel (AISI 304 / EN 1.4301 grade)
Gasket	Silicone
Lens / Reflector	High reflectance aluminium coating, multifaceted micro reflector
Glass / Diffusor	Tempered safety glass
Impact protection	IK10
Ingress protection	IP67
Input voltage	220-240V 50/60Hz
Insulation class	Class I
Weight	2.81 kg
LED module	High power LEDs on metal-core PCB
Driver	Internal LED driver
Driver surge protection	3/3 kV
Power factor	> 0.40
Through wiring	Single cable entry
Operating temperature	-40...50°C
Cable	0.3 m of rubber-sheathed cable
Notes	QUICK SHIP: Some variants will be delivered faster. Please consult the factory.

Accessories (To be ordered separately)

Mounting accessories



Case removing vacuum

160404012

Mounting accessories

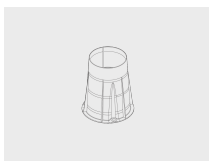

Plastic case for ZEROX S

007502091

Project name		Type		Quantity	
Date		Note			
LR9016.521-EN-WW-350-840-ONOFF-EN-C1-SS-__					

Light distribution	Rated input power	Colour temperature	Control	Product colours
[WW] Wall-wash - 46x25°	[350] 4 W	[840] 4000 K CRI 80	[ONOFF] On/Off	[SS] Stainless steel 
		[827] 2700 K CRI 80 [830] 3000 K CRI 80 [740] 4000 K CRI 70		
Extras	Accessories (<i>To be ordered separately</i>)			
Consult the factory	Mounting accessories			
[UNI] 120-277V 50/60Hz	[160404012] Case removing vacuum [007502091] Plastic case for ZEROX S			