

# ZEROX Hybrid



IK10 IP67



LR9005.695-EN-S-500-830-EN-C1-SS

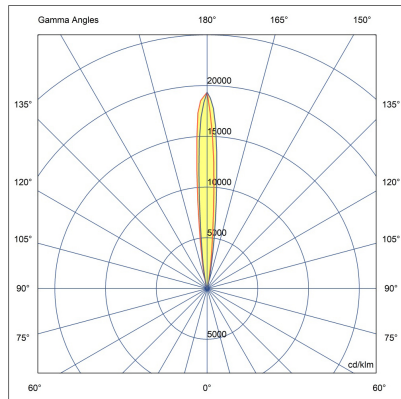
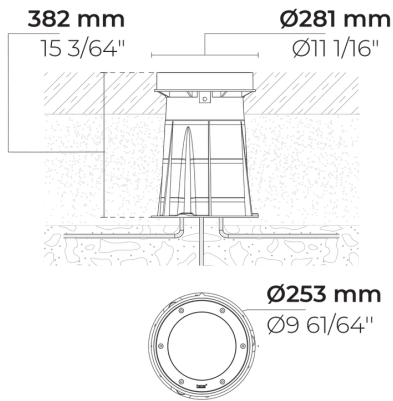

[S]  
Spot

## Variant

|                        |               |
|------------------------|---------------|
| Light distribution     | [S] 7°        |
| Delivered lumens flux  | 2622 lm       |
| Rated input power      | 28 W          |
| Colour temperature     | 3000 K CRI 80 |
| Luminaire efficacy     | 93 lm/W       |
| Lamp                   | 4 LED         |
| MacAdam Ellipse        | 5 SDCM        |
| Lifetime L90B50 (hour) | >72,600       |
| Lifetime L80B50 (hour) | >72,600       |

## Options

## Technical information

|                         |   |
|-------------------------|---|
| Mounting                | Ground recessed mountable   |
| Housing                 | Corrosion resistant stainless steel housing (AISI 316L / EN 1.4571 grade)       |
| Fasteners               | Stainless steel (AISI 304 / EN 1.4301 grade)                                    |
| Gasket                  | Silicone  |
| Lens / Reflector        | High reflectance aluminium coating  |
| Glass / Diffuser        | Tempered safety glass   |
| Impact protection       | IK10  |
| Ingress protection      | IP67  |
| Input voltage           | 220-240V 50/60Hz  |
| Insulation class        | Class I   |
| Weight                  | 6.85 kg   |
| LED module              | Multi-chip high power LEDs on metal-core PCB                                    |
| Driver                  | Internal LED driver   |
| Driver surge protection | 10/6 kV   |
| Power factor            | > 0.95  |
| Through wiring          | Single cable entry  |
| Operating temperature   | -40...50°C  |
| Cable                   | 0.3 m of rubber-sheathed cable  |
| Notes                   | QUICK SHIP: Some variants will be delivered faster. Please consult the factory. |

HPR Pazarlama A.Ş.  
Başkent OSB 22. Cd. No: 2, Malıköy, Temelli,  
Sincan, 06909 Ankara, Turkey  
+90 312 267 54 30  
info@hepergroup.com

HEPER Europe GmbH  
Ahornweg 5a, 58675  
Hemer, Germany  
+49 237 2901 2975  
infoEU@hepergroup.com

We reserve the right to change specifications without prior written notice. Edition: 12.05.2024.  
For current version visit [heperlighting.com](http://heperlighting.com). All flux (±7% tolerance) and power values (±10% tolerance) are derived following appropriate IES, CIE, and applicable standards.

## Accessories (To be ordered separately)

---

Mounting accessories



**Case removing  
vacuum**

160404012

Mounting accessories

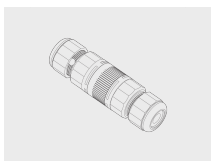

**Connector set - 5-  
pole**

141407400

Mounting accessories

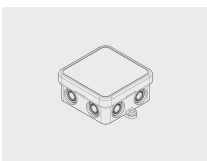

**Junction Box**

141901135

Mounting accessories

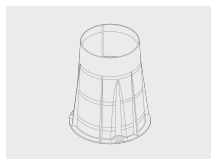

**Plastic case for  
ZEROX**

007501028

|  |  |      |  |          |  |
|--|--|------|--|----------|--|
| Project name                           |  | Type |  | Quantity |  |
| Date                                   |  | Note |  |          |  |
| LR9005.695-EN-S-500-830-__-EN-C1-SS-__ |  |      |  |          |  |

| Light distribution               | Rated input power  | Colour temperature  | Control                  | Product colours  |
|----------------------------------|--|---|--------------------------|--|
| <b>[S]</b><br>Spot - 7°          | <b>[500]</b><br>28 W   | <b>[830]</b><br>3000 K CRI 80   | <b>[ONOFF]</b><br>On/Off | <b>[SS]</b><br>Stainless steel  |
| <b>[N]</b><br>Narrow - 26°       | <b>[350]</b><br>18 W   | <b>[827]</b><br>2700 K CRI 80<br><br><b>[740]</b><br>4000 K CRI 70<br><br><b>[840]</b><br>4000 K CRI 80 | <b>[DALI]</b><br>DALI    |  |
| Extras                           | Accessories ( <i>To be ordered separately</i> )  |   |                          |  |
| Consult the factory              | Mounting accessories   |   |                          |  |
| <b>[UNI]</b><br>120-277V 50/60Hz | <b>[160404012]</b><br>Case removing vacuum<br><br><b>[141407400]</b><br>Connector set - 5-pole<br><br><b>[141901135]</b><br>Junction Box<br><br><b>[007501028]</b><br>Plastic case for ZEROX |   |                          |  |