

LR9017.522-US-WW-350-830-UNI-C1-SS

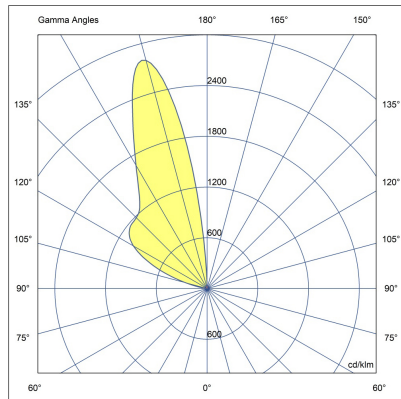
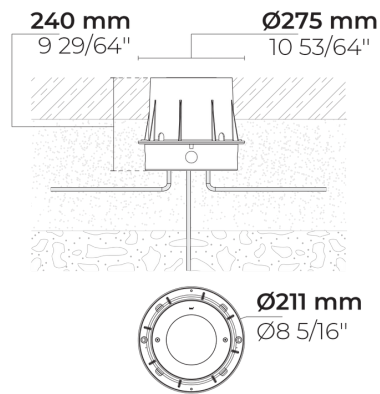

[WW]
Wall-wash

Variant

Light distribution	[WW] 35x28°
Delivered lumens flux	462 lm
Rated input power	5 W
Colour temperature	3000 K CRI 80
Luminaire efficacy	92 lm/W
Lamp	2 LED
MacAdam Ellipse	3 SDCM
Lifetime L90B50 (hour)	>42,000
Lifetime L80B50 (hour)	>42,000

Options

Technical information

Mounting	Ground recessed mountable
Housing	Corrosion resistant stainless steel housing (AISI 316L / EN 1.4571 grade)
Fasteners	Stainless steel (AISI 304 / EN 1.4301 grade)
Gasket	Silicone
Lens / Reflector	High reflectance aluminium coating, multifaceted micro reflector
Glass / Diffusor	Tempered safety glass
Impact protection	IK10
Ingress protection	IP67
Input voltage	120-277V 50/60Hz
Insulation class	Class I
Weight	8.9 lbs
LED module	High power LEDs on metal-core PCB
Driver	Internal LED driver
Driver surge protection	3/3 kV
Power factor	> 0.40
Through wiring	Single cable entry
Operating temperature	-40...50°C
Cable	0.3 m of rubber-sheathed cable

Accessories (Included)

Mounting accessories

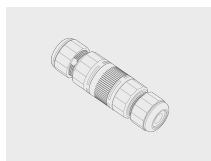

Connector set - 5-pole

141407400

Accessories (To be ordered separately)

Mounting accessories



Case removing vacuum

160404012

Mounting accessories

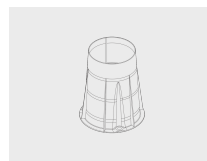

Plastic case for ZEROX M

007502092

Project name		Type		Quantity	
Date		Note			
LR9017.522-US-WW-350-830-__-UNI-C1-SS					

Light distribution	Rated input power	Colour temperature	Control	Product colours
[WW] Wall-wash - 35x28°	[350] 5 W	[830] 3000 K CRI 80	[ONOFF] On/Off	[SS] Stainless steel 
		[827] 2700 K CRI 80 [740] 4000 K CRI 70 [840] 4000 K CRI 80	[0-10V] 0-10V	
Accessories (Included)	Accessories (To be ordered separately)			
Mounting accessories	Mounting accessories			
[141407400] Connector set - 5-pole	[160404012] Case removing vacuum [007502092] Plastic case for ZEROX M			