

# ZEROX S Hybrid

IK10 IP67

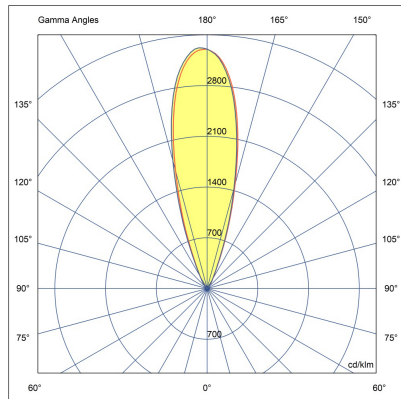

LR9016.693-US-N-700-740-UNI-C1-SS

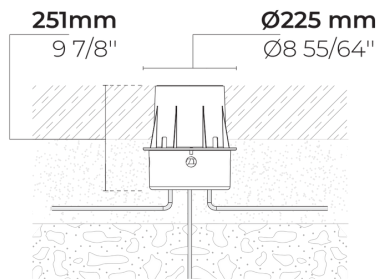

[N]  
Narrow

## Variant

|                        |               |
|------------------------|---------------|
| Light distribution     | [N] 26°       |
| Delivered lumens flux  | 1019 lm       |
| Rated input power      | 10 W          |
| Colour temperature     | 4000 K CRI 70 |
| Luminaire efficacy     | 101 lm/W      |
| Lamp                   | 1 LED         |
| MacAdam Ellipse        | 5 SDCM        |
| Lifetime L90B50 (hour) | >72,600       |
| Lifetime L80B50 (hour) | >72,600       |

## Options

## Technical information

|                         |   |
|-------------------------|---|
| Mounting                | Ground recessed mountable   |
| Housing                 | Corrosion resistant stainless steel housing (AISI 316L / EN 1.4571 grade) |
| Fasteners               | Stainless steel (AISI 304 / EN 1.4301 grade)                              |
| Gasket                  | Silicone  |
| Lens / Reflector        | High reflectance aluminium coating  |
| Glass / Diffuser        | Tempered safety glass   |
| Impact protection       | IK10  |
| Ingress protection      | IP67  |
| Input voltage           | 120-277V 50/60Hz  |
| Insulation class        | Class I   |
| Weight                  | 6.1 lbs   |
| LED module              | Multi-chip high power LEDs on metal-core PCB                              |
| Driver                  | Internal LED driver   |
| Driver surge protection | 2/2 kV  |
| Power factor            | > 0.90  |
| Through wiring          | Single cable entry  |
| Operating temperature   | -30...50°C  |
| Cable                   | 0.3 m of rubber-sheathed cable  |

## Accessories (Included)

### Mounting accessories

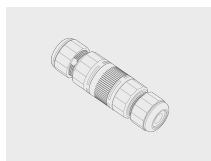

**Connector set - 5-pole**

141407400

## Accessories (To be ordered separately)

### Mounting accessories



**Case removing vacuum**

160404012

### Mounting accessories

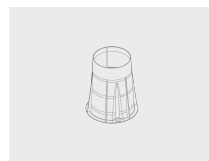

**Plastic case for ZEROX S**

007502091

|                                      |  |      |  |          |  |
|--------------------------------------|--|------|--|----------|--|
| Project name                         |  | Type |  | Quantity |  |
| Date                                 |  | Note |  |          |  |
| LR9016.693-US-N-700-740-__-UNI-C1-SS |  |      |  |          |  |

| Light distribution                           | Rated input power  | Colour temperature  | Control                  | Product colours  |
|--|--|---|--------------------------|--|
| <b>[N]</b><br>Narrow - 26°                   | <b>[700]</b><br>10 W   | <b>[740]</b><br>4000 K CRI 70   | <b>[ONOFF]</b><br>On/Off | <b>[SS]</b><br>Stainless steel  |
| <b>[S]</b><br>Spot - 7°                      | <b>[350]</b><br>5 W<br><b>[500]</b><br>6 W   | <b>[827]</b><br>2700 K CRI 80<br><b>[830]</b><br>3000 K CRI 80<br><b>[840]</b><br>4000 K CRI 80 | <b>[0-10V]</b><br>0-10V  |  |
| <b>Accessories (Included)</b>                | <b>Accessories (To be ordered separately)</b>  |   |                          |  |
| <b>Mounting accessories</b>                  | <b>Mounting accessories</b>  |   |                          |  |
| <b>[141407400]</b><br>Connector set - 5-pole | <b>[160404012]</b><br>Case removing vacuum<br><b>[007502091]</b><br>Plastic case for ZEROX S |   |                          |  |