

D-LIGHT AFX 3 Module

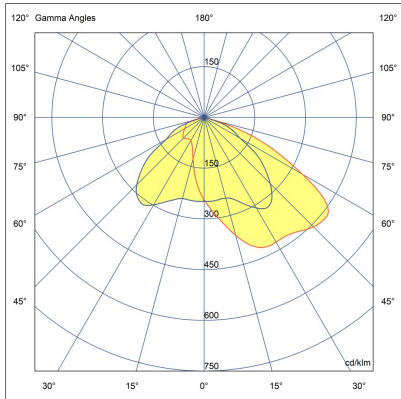

LL2023.863-US-T4-700-730

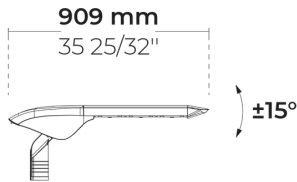

[T4]
Type IV

Configuration

| | |
|-----------------------|---------------|
| Light distribution | [T4] 117x64° |
| Delivered lumens flux | 11980 lm |
| Rated input power | 100 W |
| Color temperature | 3000 K CRI 70 |
| Luminaire efficacy | 114 lm/W |
| Lamp | 48 LED |
| Color Deviation | 3 SDCM |
| BUG rating | B2-U1-G2 |
| Lifetime L90 (hour) | >102,000 |
| Lifetime L80 (hour) | >102,000 |

Options

Technical information

| | |
|-----------------------------|---|
| Mounting | Direct pole or side bracket mountable. Tenon: Ø2 1/4" x 4" |
| Tilt angle | +15°/-15° |
| Housing | Corrosion resistant, die-cast, marine grade aluminum housing |
| Finishing | Chromate conversion pretreatment followed by electrostatic powder coating |
| Fasteners | Stainless steel (AISI 304 / EN 1.4301 grade) |
| Gasket | EPDM gasket (Shore A 20-25) |
| Lens / Reflector | PMMA lens with high optical efficiency |
| Glass / Diffusor | Tempered safety glass |
| Impact protection | IK08 |
| Ingress protection | IP66 |
| Input voltage | 120-277V 50/60Hz |
| Insulation class | Class I |
| Wind catching area (EPA) | 0.85 ft² |
| Weight | 19.09 lbs |
| LED module | High power LEDs on metal-core PCB |
| Driver | Internal LED driver |
| Driver surge protection | 10/6 kV |
| Power factor | > 0.95 |
| Through wiring | Single power cord entry |
| Operating temperature | -40...50°C |
| Power cord | 20" of outdoor use rated flexible power cord |
| Packing box dimensions | 3 15/16" x 25/32" x 5/8" |
| Pole detail | Poles are supplied with flange plate. Flange cover and anchorage can be ordered separately. Embedded base is optional |

Poles (To be ordered separately)

Round tapered aluminum poles with base plate

|  | Product code | Height | Diameter / Dimensions | Spigot / End diameter |
|---|--------------|----------------------------|-----------------------|-----------------------|
| | PAFK.D114 | 10', 13.1', 16.4' | Ø4 1/2" | Ø2 3/8", Ø3" |
| | PAFK.D122 | 13.1', 16.4', 19.7' | Ø5" | Ø2 3/8", Ø3" |
| | PAFK.D148 | 19.7', 23.0', 26.2' | Ø6" | Ø2 3/8", Ø3" |
| | PAFK.D165 | 19.7', 23.0', 26.2', 29.5' | Ø6 1/2" | Ø3 1/2", Ø3" |
| | PAFK.D180 | 26.2', 29.5', 32.8' | Ø7" | Ø3 1/2", Ø3" |
| | PAFK.D200 | 32.8', 36.1', 39.4' | Ø7 7/8" | Ø3 1/2", Ø3" |

Round tapered aluminum poles (direct burial)

|  | Product code | Height | Diameter / Dimensions | Spigot / End diameter |
|---|--------------|----------------------------|-----------------------|-----------------------|
| | PABK.D114 | 10', 13.1', 16.4' | Ø4 1/2" | Ø2 3/8", Ø3" |
| | PABK.D122 | 13.1', 16.4', 19.7', 23.0' | Ø5" | Ø2 3/8", Ø3" |
| | PABK.D148 | 19.7', 23.0', 26.2' | Ø6" | Ø2 3/8", Ø3" |
| | PABK.D165 | 19.7', 23.0', 26.2', 29.5' | Ø6 1/2" | Ø3 1/2", Ø3" |
| | PABK.D180 | 26.2', 29.5', 32.8' | Ø7" | Ø3 1/2", Ø3" |
| | PABK.D200 | 32.8', 36.1', 39.4' | Ø7 7/8" | Ø3 1/2", Ø3" |

Round cylindrical aluminum poles with base plate

|  | Product code | Height | Diameter / Dimensions | Spigot / End diameter |
|---|--------------|----------------------------|-----------------------|-----------------------|
| | PAFC.D114 | 10', 13.1', 16.4' | Ø4 1/2" | Ø4 1/2" |
| | PAFC.D122 | 10', 13.1', 16.4', 19.7' | Ø5" | Ø4 51/64" |
| | PAFC.D148 | 19.7', 23.0', 26.2' | Ø6" | Ø5 7/8" |
| | PAFC.D165 | 19.7', 23.0', 26.2', 29.5' | Ø6 1/2" | Ø6 1/2" |

Accessories (To be ordered separately)

Mounting accessories

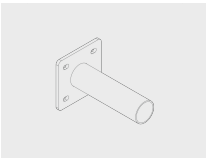

Wall mounting bracket

B6A.03.03.01001.0220

| | | | | | | | |
|--------------|--|------|--|------|--|----------|--|
| Project name | | | | Type | | Quantity | |
| Date | | Note | | | | | |

LL2023.863-US-T4-700-730-__-__-__-__-__-__

| Light distribution | Rated input power | Color temperature | Control | Product colors |
|--|--|--|--|---|
| <div>[T4] Type IV - 117x64°</div> <div>[P4] Pedestrian crosswalk distribution - 20x78°</div> <div>[T1] Type I - 111x48°</div> <div>[T2] Type II - 133x48°</div> <div>[T2] Type II - 149x54°</div> <div>[T3] Type III - 143x63°</div> <div>[T5] Type V - 117°</div> | <div>[700] 100 W</div> <div>[350] 50 W</div> <div>[500] 72 W</div> | <div>[730] 3000 K CRI 70</div> <div>[830] 3000 K CRI 80</div> <div>[740] 4000 K CRI 70</div> | <div>[ONOFF] On/Off</div> <div>[0-10V] 0-10V</div> | <div>[HM3] Anthracite gray</div> <div>[HM4] Light gray</div> <div>[CC] Custom color (Please specify RAL code)</div> |
| Extras | Accessories (<i>To be ordered separately</i>) | | | |
| External surge protection | Mounting accessories | | | |
| [SP10] 10 kV | [B6A.03.03.01001.0220] Wall mounting bracket | | | |
| Connectivity | | | | |
| [NM7] 7 Pin NEMA socket | | | | |
| Luminaire body options | | | | |
| [DPC] Double powder coating | | | | |