

D-LIGHT AFX 3 Module

CE  UK CA IK08 IP66 

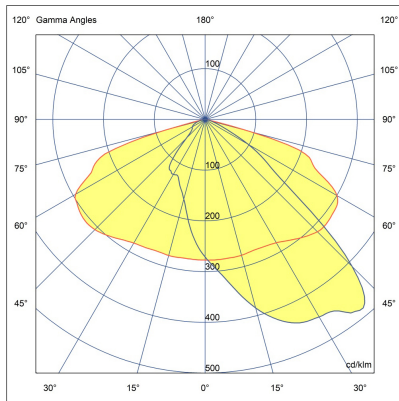

LL2023.863-EN-T2-2-350-740-EN-C1

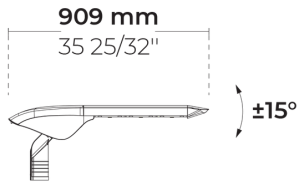

[T2]

Type II, Asymmetric,
Side throw

Variant

| | |
|-------------------------------|---------------|
| Light distribution | [T2] 149x54° |
| Delivered lumens flux | 6870 lm |
| Rated input power | 50 W |
| Colour temperature | 4000 K CRI 70 |
| Luminaire efficacy | 135 lm/W |
| Lamp | 48 LED |
| MacAdam Ellipse | 4 SDCM |
| BUG rating | B2-U0-G1 |
| Lifetime L90B50 (hour) | >102,000 |
| Lifetime L80B50 (hour) | >102,000 |

Options

Technical information

| | |
|---------------------------------|---|
| Mounting | Direct pole or side bracket mountable. Spigot: Ø60 mm x 100 mm |
| Tilt angle | +15°/-15° |
| Housing | Corrosion resistant, die-cast, marine grade aluminum housing |
| Finishing | Chromate conversion pretreatment followed by electrostatic powder coating |
| Fasteners | Stainless steel (AISI 304 / EN 1.4301 grade) |
| Gasket | EPDM gasket (Shore A 20-25) |
| Lens / Reflector | PMMA lens with high optical efficiency |
| Glass / Diffusor | Tempered safety glass |
| Impact protection | IK08 |
| Ingress protection | IP66 |
| Input voltage | 220-240V 50/60Hz |
| Insulation class | Class I |
| Wind catching area (EPA) | 0.08 m ² |
| Weight | 8.68 kg |
| LED module | High power LEDs on metal-core PCB |
| Driver | Internal LED driver |
| Driver surge protection | 10/6 kV |
| Power factor | > 0.98 |
| Through wiring | Single cable entry |
| Operating temperature | -40...50°C |
| Cable | 0.5 m of flexible cable |
| Packing box dimensions | 100*20*16 cm |
| Pole detail | Poles are supplied with flange plate. Flange cover and anchorage can be ordered separately. Embedded base is optional |
| Notes | This product can be supplied with Insulation class (Class II) upon request. Please contact factory. |

HPR Pazarlama A.Ş.
Başkent OSB 22. Cd. No: 2, Malıköy, Temelli,
Sincan, 06909 Ankara, Turkey
+90 312 267 54 30
info@hepergroup.com

HEPER Europe GmbH
Ahornweg 5a, 58675
Hemer, Germany
+49 237 2901 2975
infoEU@hepergroup.com

We reserve the right to change specifications without prior written notice. Edition: 28.06.2024. For current version visit heperlighting.com. All flux (±7% tolerance) and power values (±10% tolerance) are derived following appropriate IES, CIE, and applicable standards.

Poles (To be ordered separately)

Cylindrical aluminum poles with flange plate

| Product code | Height | Diameter / Dimensions | Spigot diameter |
|--------------|---------------------|-----------------------|-----------------|
| PAFC.D114 | 3m, 4m, 5m m | Ø114mm | Ø114mm mm |
| PAFC.D122 | 3m, 4m, 5m, 6m m | Ø122mm | Ø122mm mm |
| PAFC.D148 | 6m, 7m, 8m m | Ø148mm | Ø148mm mm |
| PAFC.D165 | 6m, 7m, 8m, 9m m | Ø165mm | Ø165mm mm |

Conical aluminum poles with embedded base

| Product code | Height | Diameter / Dimensions | Spigot diameter |
|--------------|---------------------|-----------------------|--------------------|
| PABK.D114 | 3m, 4m, 5m m | Ø114mm | Ø60mm, Ø76mm mm |
| PABK.D122 | 4m, 5m, 6m, 7m m | Ø122mm | Ø60mm, Ø76mm mm |
| PABK.D148 | 6m, 7m, 8m m | Ø148mm | Ø60mm, Ø76mm mm |
| PABK.D165 | 6m, 7m, 8m, 9m m | Ø165mm | Ø76mm, Ø90mm mm |
| PABK.D180 | 10m, 8m, 9m m | Ø180mm | Ø76mm, Ø90mm mm |
| PABK.D200 | 10m, 11m, 12m m | Ø200mm | Ø76mm, Ø90mm mm |

Conical aluminum poles with flange plate

| Product code | Height | Diameter / Dimensions | Spigot diameter |
|--------------|---------------------|-----------------------|--------------------|
| PAFK.D114 | 3m, 4m, 5m m | Ø114mm | Ø60mm, Ø76mm mm |
| PAFK.D122 | 4m, 5m, 6m m | Ø122mm | Ø60mm, Ø76mm mm |
| PAFK.D148 | 6m, 7m, 8m m | Ø148mm | Ø60mm, Ø76mm mm |
| PAFK.D165 | 6m, 7m, 8m, 9m m | Ø165mm | Ø76mm, Ø90mm mm |
| PAFK.D180 | 10m, 8m, 9m m | Ø180mm | Ø76mm, Ø90mm mm |
| PAFK.D200 | 10m, 11m, 12m m | Ø200mm | Ø76mm, Ø90mm mm |

Accessories (To be ordered separately)

Mounting accessories

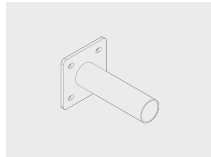

**Wall mounting
bracket**

B6A.03.03.01001.0220

| External surge protection | Mounting accessories |
|---------------------------------------|--|
| [SP10] 10 kV | [B6A.03.03.01001.0220] Wall mounting bracket |
| Connectivity | |
| [NM7] NEMA socket - 7 Pin | |
| Light output | |
| [CLO] Constant light output | |
| Consult the factory | |
| [C2] Class II | |
| [UNI] 120-277V 50/60Hz | |
| Luminaire body options | |
| [DPC] Double powder coating | |