

D-LIGHT AFX 3 Module

LL2023.863-US

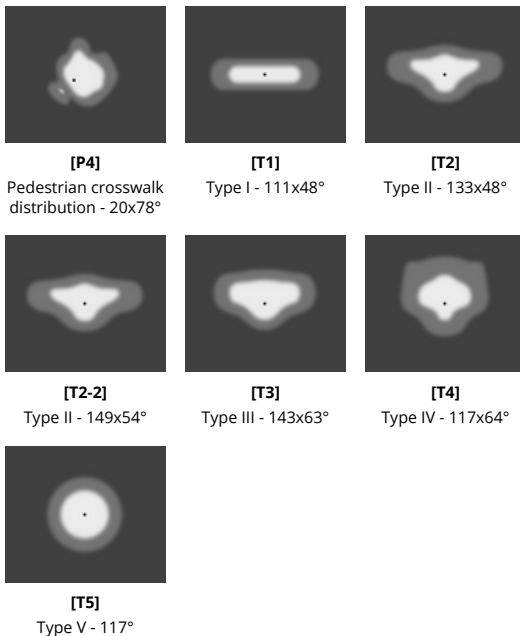
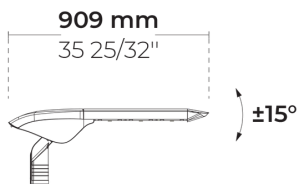

Configurations

Light distribution	[P4] 20x78°, [T1] 111x48°, [T2] 133x48°, [T2-2] 149x54°, [T3] 143x63°, [T4] 117x64°, [T5] 117°
Delivered lumens flux	5675 - 13800 lm
Rated input power	50 - 100 W
Color temperature	3000 K CRI 70, 3000 K CRI 80, 4000 K CRI 70
BUG rating	B2-U0-G1, B3-U1-G1, B1-U0-G1, B2-U0-G0, B2-U1-G1, B1-U1-G1, B3-U0-G1, B3-U0-G0, B3-U1-G2, B2-U1-G2
Lifetime L90 (hour)	>102, 000
Lifetime L80 (hour)	>102, 000

Options

Control	On/Off, 0-10V
Product colors	

Extras

External surge protection	10 kV
Connectivity	7 Pin NEMA socket
Luminaire body options	Double powder coating

Technical information

Mounting	Direct pole or side bracket mountable. Tenon: Ø2 1/4" x 4"
Tilt angle	+15°/-15°
Housing	Corrosion resistant, die-cast, marine grade aluminum housing
Finishing	Chromate conversion pretreatment followed by electrostatic powder coating
Fasteners	Stainless steel (AISI 304 / EN 1.4301 grade)
Gasket	EPDM gasket (Shore A 20-25)
Lens / Reflector	PMMA lens with high optical efficiency
Glass / Diffusor	Tempered safety glass
Impact protection	IK08
Ingress protection	IP66
Input voltage	120-277V 50/60Hz
Insulation class	Class I
Wind catching area (EPA)	0.85 ft²
Weight	19.09 lbs
LED module	High power LEDs on metal-core PCB
Driver	Internal LED driver
Driver surge protection	10/6 kV
Power factor	> 0.95
Through wiring	Single power cord entry
Operating temperature	-40...50°C
Power cord	20" of outdoor use rated flexible power cord
Packing box	3 15/16"*25/32"*5/8"

dimensions

Pole detail

Poles are supplied with flange plate. Flange cover and anchorage can be ordered separately. Embedded base is optional

Poles (To be ordered separately)

Round tapered aluminum poles with base plate

	Product code	Height	Diameter / Dimensions	Spigot / End diameter
	PAFK.D114	10', 13.1', 16.4'	Ø4 1/2"	Ø2 3/8", Ø3"
	PAFK.D122	13.1', 16.4', 19.7'	Ø5"	Ø2 3/8", Ø3"
	PAFK.D148	19.7', 23.0', 26.2'	Ø6"	Ø2 3/8", Ø3"
	PAFK.D165	19.7', 23.0', 26.2', 29.5'	Ø6 1/2"	Ø3 1/2", Ø3"
	PAFK.D180	26.2', 29.5', 32.8'	Ø7"	Ø3 1/2", Ø3"
	PAFK.D200	32.8', 36.1', 39.4'	Ø7 7/8"	Ø3 1/2", Ø3"

Round tapered aluminum poles (direct burial)

	Product code	Height	Diameter / Dimensions	Spigot / End diameter
	PABK.D114	10', 13.1', 16.4'	Ø4 1/2"	Ø2 3/8", Ø3"
	PABK.D122	13.1', 16.4', 19.7', 23.0'	Ø5"	Ø2 3/8", Ø3"
	PABK.D148	19.7', 23.0', 26.2'	Ø6"	Ø2 3/8", Ø3"
	PABK.D165	19.7', 23.0', 26.2', 29.5'	Ø6 1/2"	Ø3 1/2", Ø3"
	PABK.D180	26.2', 29.5', 32.8'	Ø7"	Ø3 1/2", Ø3"
	PABK.D200	32.8', 36.1', 39.4'	Ø7 7/8"	Ø3 1/2", Ø3"

Round cylindrical aluminum poles with base plate

	Product code	Height	Diameter / Dimensions	Spigot / End diameter
	PAFC.D114	10', 13.1', 16.4'	Ø4 1/2"	Ø4 1/2"
	PAFC.D122	10', 13.1', 16.4', 19.7'	Ø5"	Ø4 51/64"
	PAFC.D148	19.7', 23.0', 26.2'	Ø6"	Ø5 7/8"
	PAFC.D165	19.7', 23.0', 26.2', 29.5'	Ø6 1/2"	Ø6 1/2"

Accessories (To be ordered separately)

Mounting accessories

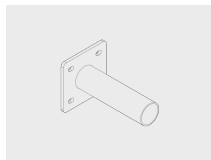



Wall mounting bracket

B6A.03.03.01001.0220

Project name		Type		Quantity	
Date		Note			

LL2023.863-US- _ _ _ _ _

Light distribution	Rated input power	Color temperature	Control	Product colors
[P4] Pedestrian crosswalk distribution - 20x78° [T1] Type I - 111x48° [T2] Type II - 133x48° [T2-2] Type II - 149x54° [T3] Type III - 143x63° [T4] Type IV - 117x64° [T5] Type V - 117°	[350] 50 W [500] 72 W [700] 100 W	[730] 3000 K CRI 70 [830] 3000 K CRI 80 [740] 4000 K CRI 70	[ONOFF] On/Off [0-10V] 0-10V	[HM3]  Anthracite gray [HM4]  Light gray [CC]  Custom color (Please specify RAL code)
Extras	Accessories (To be ordered separately)			
External surge protection	Mounting accessories			
[SP10] 10 kV	[B6A.03.03.01001.0220] Wall mounting bracket			
Connectivity				
[NM7] 7 Pin NEMA socket				
Luminaire body options				
[DPC] Double powder coating				

Configuration code	Light distribution	Delivered lumens flux	Rated input power	Color temperature	Control
LL2023.863-US-T1-350-730	[T1] Type I - 111x48°	6800 lm	50 W	3000 K CRI 70	On/Off, 0-10V
LL2023.863-US-T1-350-740	[T1] Type I - 111x48°	7240 lm	50 W	4000 K CRI 70	On/Off, 0-10V
LL2023.863-US-T1-350-830	[T1] Type I - 111x48°	6350 lm	50 W	3000 K CRI 80	On/Off, 0-10V
LL2023.863-US-T1-500-730	[T1] Type I - 111x48°	9620 lm	72 W	3000 K CRI 70	On/Off, 0-10V
LL2023.863-US-T1-500-740	[T1] Type I - 111x48°	10150 lm	72 W	4000 K CRI 70	On/Off, 0-10V
LL2023.863-US-T1-500-830	[T1] Type I - 111x48°	9040 lm	72 W	3000 K CRI 80	On/Off, 0-10V
LL2023.863-US-T1-700-730	[T1] Type I - 111x48°	12410 lm	100 W	3000 K CRI 70	On/Off, 0-10V
LL2023.863-US-T1-700-740	[T1] Type I - 111x48°	13120 lm	100 W	4000 K CRI 70	On/Off, 0-10V
LL2023.863-US-T1-700-830	[T1] Type I - 111x48°	11715 lm	100 W	3000 K CRI 80	On/Off, 0-10V
LL2023.863-US-T2-350-730	[T2] Type II - 133x48°	6350 lm	50 W	3000 K CRI 70	On/Off, 0-10V
LL2023.863-US-T2-350-740	[T2] Type II - 133x48°	6760 lm	50 W	4000 K CRI 70	On/Off, 0-10V
LL2023.863-US-T2-350-830	[T2] Type II - 133x48°	5930 lm	50 W	3000 K CRI 80	On/Off, 0-10V
LL2023.863-US-T2-500-730	[T2] Type II - 133x48°	9640 lm	72 W	3000 K CRI 70	On/Off, 0-10V
LL2023.863-US-T2-500-740	[T2] Type II - 133x48°	10675 lm	72 W	4000 K CRI 70	On/Off, 0-10V
LL2023.863-US-T2-500-830	[T2] Type II - 133x48°	9510 lm	72 W	3000 K CRI 80	On/Off, 0-10V
LL2023.863-US-T2-700-730	[T2] Type II - 133x48°	12440 lm	100 W	3000 K CRI 70	On/Off, 0-10V
LL2023.863-US-T2-700-740	[T2] Type II - 133x48°	13800 lm	100 W	4000 K CRI 70	On/Off, 0-10V
LL2023.863-US-T2-700-830	[T2] Type II - 133x48°	12323 lm	100 W	3000 K CRI 80	On/Off, 0-10V
LL2023.863-US-T2-2-350-730	[T2] Type II - 149x54°	6450 lm	50 W	3000 K CRI 70	On/Off, 0-10V
LL2023.863-US-T2-2-350-740	[T2] Type II - 149x54°	6870 lm	50 W	4000 K CRI 70	On/Off, 0-10V
LL2023.863-US-T2-2-350-830	[T2] Type II - 149x54°	6030 lm	50 W	3000 K CRI 80	On/Off, 0-10V
LL2023.863-US-T2-2-500-730	[T2] Type II - 149x54°	9405 lm	72 W	3000 K CRI 70	On/Off, 0-10V
LL2023.863-US-T2-2-500-740	[T2] Type II - 149x54°	10150 lm	72 W	4000 K CRI 70	On/Off, 0-10V
LL2023.863-US-T2-2-500-830	[T2] Type II - 149x54°	9040 lm	72 W	3000 K CRI 80	On/Off, 0-10V
LL2023.863-US-T2-2-700-730	[T2] Type II - 149x54°	12135 lm	100 W	3000 K CRI 70	On/Off, 0-10V
LL2023.863-US-T2-2-700-740	[T2] Type II - 149x54°	13120 lm	100 W	4000 K CRI 70	On/Off, 0-10V
LL2023.863-US-T2-2-700-830	[T2] Type II - 149x54°	11715 lm	100 W	3000 K CRI 80	On/Off, 0-10V
LL2023.863-US-T3-350-730	[T3] Type III - 143x63°	6070 lm	50 W	3000 K CRI 70	On/Off, 0-10V
LL2023.863-US-T3-350-740	[T3] Type III - 143x63°	6470 lm	50 W	4000 K CRI 70	On/Off, 0-10V
LL2023.863-US-T3-350-830	[T3] Type III - 143x63°	5675 lm	50 W	3000 K CRI 80	On/Off, 0-10V
LL2023.863-US-T3-500-730	[T3] Type III - 143x63°	8930 lm	72 W	3000 K CRI 70	On/Off, 0-10V
LL2023.863-US-T3-500-740	[T3] Type III - 143x63°	9550 lm	72 W	4000 K CRI 70	On/Off, 0-10V
LL2023.863-US-T3-500-830	[T3] Type III - 143x63°	8505 lm	72 W	3000 K CRI 80	On/Off, 0-10V
LL2023.863-US-T3-700-730	[T3] Type III - 143x63°	11520 lm	100 W	3000 K CRI 70	On/Off, 0-10V
LL2023.863-US-T3-700-740	[T3] Type III - 143x63°	12345 lm	100 W	4000 K CRI 70	On/Off, 0-10V
LL2023.863-US-T3-700-830	[T3] Type III - 143x63°	11020 lm	100 W	3000 K CRI 80	On/Off, 0-10V
LL2023.863-US-T4-350-730	[T4] Type IV - 117x64°	6365 lm	50 W	3000 K CRI 70	On/Off, 0-10V
LL2023.863-US-T4-350-740	[T4] Type IV - 117x64°	6775 lm	50 W	4000 K CRI 70	On/Off, 0-10V
LL2023.863-US-T4-350-830	[T4] Type IV - 117x64°	5945 lm	50 W	3000 K CRI 80	On/Off, 0-10V
LL2023.863-US-T4-500-730	[T4] Type IV - 117x64°	9285 lm	72 W	3000 K CRI 70	On/Off, 0-10V

LL2023.863-US-T4-500-740	[T4] Type IV - 117x64°	10005 lm	72 W	4000 K CRI 70	On/Off, 0-10V
LL2023.863-US-T4-500-830	[T4] Type IV - 117x64°	8910 lm	72 W	3000 K CRI 80	On/Off, 0-10V
LL2023.863-US-T4-700-730	[T4] Type IV - 117x64°	11980 lm	100 W	3000 K CRI 70	On/Off, 0-10V
LL2023.863-US-T4-700-740	[T4] Type IV - 117x64°	12935 lm	100 W	4000 K CRI 70	On/Off, 0-10V
LL2023.863-US-T4-700-830	[T4] Type IV - 117x64°	11550 lm	100 W	3000 K CRI 80	On/Off, 0-10V
LL2023.863-US-T5-350-730	[T5] Type V - 117°	6605 lm	50 W	3000 K CRI 70	On/Off, 0-10V
LL2023.863-US-T5-350-740	[T5] Type V - 117°	7035 lm	50 W	4000 K CRI 70	On/Off, 0-10V
LL2023.863-US-T5-350-830	[T5] Type V - 117°	6170 lm	50 W	3000 K CRI 80	On/Off, 0-10V
LL2023.863-US-T5-500-730	[T5] Type V - 117°	9762 lm	72 W	3000 K CRI 70	On/Off, 0-10V
LL2023.863-US-T5-500-740	[T5] Type V - 117°	10615 lm	72 W	4000 K CRI 70	On/Off, 0-10V
LL2023.863-US-T5-500-830	[T5] Type V - 117°	9380 lm	72 W	3000 K CRI 80	On/Off, 0-10V
LL2023.863-US-T5-700-730	[T5] Type V - 117°	12595 lm	100 W	3000 K CRI 70	On/Off, 0-10V
LL2023.863-US-T5-700-740	[T5] Type V - 117°	13720 lm	100 W	4000 K CRI 70	On/Off, 0-10V
LL2023.863-US-T5-700-830	[T5] Type V - 117°	12250 lm	100 W	3000 K CRI 80	On/Off, 0-10V
LL2023.863-US-P4-350-730	[P4] Pedestrian crosswalk distribution - 20x78°	6605 lm	50 W	3000 K CRI 70	On/Off, 0-10V
LL2023.863-US-P4-350-740	[P4] Pedestrian crosswalk distribution - 20x78°	7035 lm	50 W	4000 K CRI 70	On/Off, 0-10V
LL2023.863-US-P4-350-830	[P4] Pedestrian crosswalk distribution - 20x78°	6170 lm	50 W	3000 K CRI 80	On/Off, 0-10V
LL2023.863-US-P4-500-730	[P4] Pedestrian crosswalk distribution - 20x78°	9645 lm	72 W	3000 K CRI 70	On/Off, 0-10V
LL2023.863-US-P4-500-740	[P4] Pedestrian crosswalk distribution - 20x78°	10530 lm	72 W	4000 K CRI 70	On/Off, 0-10V
LL2023.863-US-P4-500-830	[P4] Pedestrian crosswalk distribution - 20x78°	9380 lm	72 W	3000 K CRI 80	On/Off, 0-10V
LL2023.863-US-P4-700-730	[P4] Pedestrian crosswalk distribution - 20x78°	12440 lm	100 W	3000 K CRI 70	On/Off, 0-10V
LL2023.863-US-P4-700-740	[P4] Pedestrian crosswalk distribution - 20x78°	13610 lm	100 W	4000 K CRI 70	On/Off, 0-10V
LL2023.863-US-P4-700-830	[P4] Pedestrian crosswalk distribution - 20x78°	12155 lm	100 W	3000 K CRI 80	On/Off, 0-10V