

D-LIGHT AFX 2 Module

LL2023.862-US

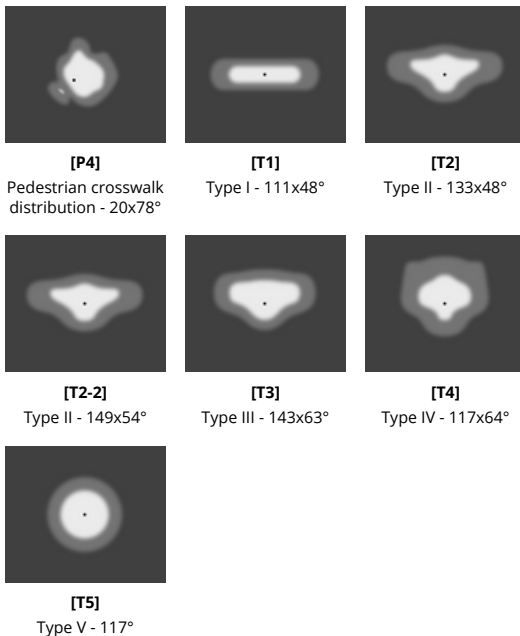
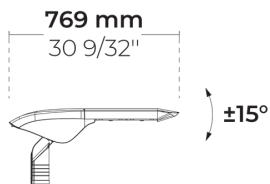

Configurations

Light distribution	[P4] 20x78°, [T1] 111x48°, [T2] 133x48°, [T2-2] 149x54°, [T3] 143x63°, [T4] 117x64°, [T5] 117°
Delivered lumens flux	3785 - 9085 lm
Rated input power	34 - 67 W
Color temperature	3000 K CRI 70, 3000 K CRI 80, 4000 K CRI 70
BUG rating	B1-U0-G1, B2-U0-G1, B2-U1-G1, B3-U0-G1, B1-U0-G0, B1-U1-G1, B2-U0-G0, B3-U0-G0
Lifetime L90 (hour)	>102, 000
Lifetime L80 (hour)	>102, 000

Options

Control	On/Off, 0-10V
Product colors	

Extras

External surge protection	10 kV
Connectivity	7 Pin NEMA socket
Luminaire body options	Double powder coating

Technical information

Mounting	Direct pole or side bracket mountable. Tenon: Ø2 1/4" x 4"
Tilt angle	+15°/-15°
Housing	Corrosion resistant, die-cast, marine grade aluminum housing
Finishing	Chromate conversion pretreatment followed by electrostatic powder coating
Fasteners	Stainless steel (AISI 304 / EN 1.4301 grade)
Gasket	EPDM gasket (Shore A 20-25)
Lens / Reflector	PMMA lens with high optical efficiency
Glass / Diffusor	Tempered safety glass
Impact protection	IK08
Ingress protection	IP66
Input voltage	120-277V 50/60Hz
Insulation class	Class I
Wind catching area (EPA)	0.77 ft²
Weight	16.87 lbs
LED module	High power LEDs on metal-core PCB
Driver	Internal LED driver
Driver surge protection	4/2 kV
Power factor	> 0.90
Through wiring	Single power cord entry
Operating temperature	-40...50°C
Power cord	20" of outdoor use rated flexible power cord
Packing box	30 5/16" * 7 7/8" * 6 19/64"

dimensions

Pole detail

Poles are supplied with flange plate. Flange cover and anchorage can be ordered separately. Embedded base is optional

Poles (To be ordered separately)

Round tapered aluminum poles with base plate

	Product code	Height	Diameter / Dimensions	Spigot / End diameter
	PAFK.D114	10', 13.1', 16.4'	Ø4 1/2"	Ø2 3/8", Ø3"
	PAFK.D122	13.1', 16.4', 19.7'	Ø5"	Ø2 3/8", Ø3"
	PAFK.D148	19.7', 23.0', 26.2'	Ø6"	Ø2 3/8", Ø3"
	PAFK.D165	19.7', 23.0', 26.2', 29.5'	Ø6 1/2"	Ø3 1/2", Ø3"
	PAFK.D180	26.2', 29.5', 32.8'	Ø7"	Ø3 1/2", Ø3"
	PAFK.D200	32.8', 36.1', 39.4'	Ø7 7/8"	Ø3 1/2", Ø3"

Round tapered aluminum poles (direct burial)

	Product code	Height	Diameter / Dimensions	Spigot / End diameter
	PABK.D114	10', 13.1', 16.4'	Ø4 1/2"	Ø2 3/8", Ø3"
	PABK.D122	13.1', 16.4', 19.7', 23.0'	Ø5"	Ø2 3/8", Ø3"
	PABK.D148	19.7', 23.0', 26.2'	Ø6"	Ø2 3/8", Ø3"
	PABK.D165	19.7', 23.0', 26.2', 29.5'	Ø6 1/2"	Ø3 1/2", Ø3"
	PABK.D180	26.2', 29.5', 32.8'	Ø7"	Ø3 1/2", Ø3"
	PABK.D200	32.8', 36.1', 39.4'	Ø7 7/8"	Ø3 1/2", Ø3"

Round cylindrical aluminum poles with base plate

	Product code	Height	Diameter / Dimensions	Spigot / End diameter
	PAFC.D114	10', 13.1', 16.4'	Ø4 1/2"	Ø4 1/2"
	PAFC.D122	10', 13.1', 16.4', 19.7'	Ø5"	Ø4 51/64"
	PAFC.D148	19.7', 23.0', 26.2'	Ø6"	Ø5 7/8"
	PAFC.D165	19.7', 23.0', 26.2', 29.5'	Ø6 1/2"	Ø6 1/2"

Accessories (To be ordered separately)

Mounting accessories

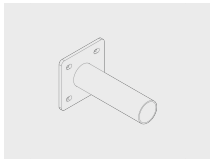



Wall mounting bracket

B6A.03.03.01001.0220

Project name		Type		Quantity	
Date		Note			

LL2023.862-US- - - - - - - - - - -

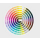
Light distribution	Rated input power	Color temperature	Control	Product colors
[P4] Pedestrian crosswalk distribution - 20x78° [T1] Type I - 111x48° [T2] Type II - 133x48° [T2-2] Type II - 149x54° [T3] Type III - 143x63° [T4] Type IV - 117x64° [T5] Type V - 117°	[350] 34 W [500] 48 W [700] 67 W	[730] 3000 K CRI 70 [830] 3000 K CRI 80 [740] 4000 K CRI 70	[ONOFF] On/Off [0-10V] 0-10V	[HM3]  Anthracite gray [HM4]  Light gray [CC]  Custom color (Please specify RAL code)
Extras	Accessories (To be ordered separately)			
External surge protection	Mounting accessories			
[SP10] 10 kV	[B6A.03.03.01001.0220] Wall mounting bracket			
Connectivity				
[NM7] 7 Pin NEMA socket				
Luminaire body options				
[DPC] Double powder coating				

Configuration code	Light distribution	Delivered lumens flux	Rated input power	Color temperature	Control
LL2023.862-US-T1-350-730	[T1] Type I - 111x48°	4530 lm	34 W	3000 K CRI 70	On/Off, 0-10V
LL2023.862-US-T1-350-740	[T1] Type I - 111x48°	4830 lm	34 W	4000 K CRI 70	On/Off, 0-10V
LL2023.862-US-T1-350-830	[T1] Type I - 111x48°	4235 lm	34 W	3000 K CRI 80	On/Off, 0-10V
LL2023.862-US-T1-500-730	[T1] Type I - 111x48°	6415 lm	48 W	3000 K CRI 70	On/Off, 0-10V
LL2023.862-US-T1-500-740	[T1] Type I - 111x48°	6785 lm	48 W	4000 K CRI 70	On/Off, 0-10V
LL2023.862-US-T1-500-830	[T1] Type I - 111x48°	5790 lm	48 W	3000 K CRI 80	On/Off, 0-10V
LL2023.862-US-T1-700-730	[T1] Type I - 111x48°	8270 lm	67 W	3000 K CRI 70	On/Off, 0-10V
LL2023.862-US-T1-700-740	[T1] Type I - 111x48°	8925 lm	67 W	4000 K CRI 70	On/Off, 0-10V
LL2023.862-US-T1-700-830	[T1] Type I - 111x48°	7500 lm	67 W	3000 K CRI 80	On/Off, 0-10V
LL2023.862-US-T2-350-730	[T2] Type II - 133x48°	4230 lm	34 W	3000 K CRI 70	On/Off, 0-10V
LL2023.862-US-T2-350-740	[T2] Type II - 133x48°	4510 lm	34 W	4000 K CRI 70	On/Off, 0-10V
LL2023.862-US-T2-350-830	[T2] Type II - 133x48°	3955 lm	34 W	3000 K CRI 80	On/Off, 0-10V
LL2023.862-US-T2-500-730	[T2] Type II - 133x48°	6270 lm	48 W	3000 K CRI 70	On/Off, 0-10V
LL2023.862-US-T2-500-740	[T2] Type II - 133x48°	6880 lm	48 W	4000 K CRI 70	On/Off, 0-10V
LL2023.862-US-T2-500-830	[T2] Type II - 133x48°	5870 lm	48 W	3000 K CRI 80	On/Off, 0-10V
LL2023.862-US-T2-700-730	[T2] Type II - 133x48°	8385 lm	67 W	3000 K CRI 70	On/Off, 0-10V
LL2023.862-US-T2-700-740	[T2] Type II - 133x48°	9085 lm	67 W	4000 K CRI 70	On/Off, 0-10V
LL2023.862-US-T2-700-830	[T2] Type II - 133x48°	6980 lm	67 W	3000 K CRI 80	On/Off, 0-10V
LL2023.862-US-T2-2-350-730	[T2] Type II - 149x54°	4300 lm	34 W	3000 K CRI 70	On/Off, 0-10V
LL2023.862-US-T2-2-350-740	[T2] Type II - 149x54°	4585 lm	34 W	4000 K CRI 70	On/Off, 0-10V
LL2023.862-US-T2-2-350-830	[T2] Type II - 149x54°	4020 lm	34 W	3000 K CRI 80	On/Off, 0-10V
LL2023.862-US-T2-2-500-730	[T2] Type II - 149x54°	6500 lm	48 W	3000 K CRI 70	On/Off, 0-10V
LL2023.862-US-T2-2-500-740	[T2] Type II - 149x54°	6635 lm	48 W	4000 K CRI 70	On/Off, 0-10V
LL2023.862-US-T2-2-500-830	[T2] Type II - 149x54°	5665 lm	48 W	3000 K CRI 80	On/Off, 0-10V
LL2023.862-US-T2-2-700-730	[T2] Type II - 149x54°	8090 lm	67 W	3000 K CRI 70	On/Off, 0-10V
LL2023.862-US-T2-2-700-740	[T2] Type II - 149x54°	8675 lm	67 W	4000 K CRI 70	On/Off, 0-10V
LL2023.862-US-T2-2-700-830	[T2] Type II - 149x54°	7600 lm	67 W	3000 K CRI 80	On/Off, 0-10V
LL2023.862-US-T3-350-730	[T3] Type III - 143x63°	4045 lm	34 W	3000 K CRI 70	On/Off, 0-10V
LL2023.862-US-T3-350-740	[T3] Type III - 143x63°	4315 lm	34 W	4000 K CRI 70	On/Off, 0-10V
LL2023.862-US-T3-350-830	[T3] Type III - 143x63°	3785 lm	34 W	3000 K CRI 80	On/Off, 0-10V
LL2023.862-US-T3-500-730	[T3] Type III - 143x63°	5970 lm	48 W	3000 K CRI 70	On/Off, 0-10V
LL2023.862-US-T3-500-740	[T3] Type III - 143x63°	6315 lm	48 W	4000 K CRI 70	On/Off, 0-10V
LL2023.862-US-T3-500-830	[T3] Type III - 143x63°	5390 lm	48 W	3000 K CRI 80	On/Off, 0-10V
LL2023.862-US-T3-700-730	[T3] Type III - 143x63°	7700 lm	67 W	3000 K CRI 70	On/Off, 0-10V
LL2023.862-US-T3-700-740	[T3] Type III - 143x63°	8240 lm	67 W	4000 K CRI 70	On/Off, 0-10V
LL2023.862-US-T3-700-830	[T3] Type III - 143x63°	6980 lm	67 W	3000 K CRI 80	On/Off, 0-10V
LL2023.862-US-T4-350-730	[T4] Type IV - 117x64°	4240 lm	34 W	3000 K CRI 70	On/Off, 0-10V
LL2023.862-US-T4-350-740	[T4] Type IV - 117x64°	4520 lm	34 W	4000 K CRI 70	On/Off, 0-10V
LL2023.862-US-T4-350-830	[T4] Type IV - 117x64°	3965 lm	34 W	3000 K CRI 80	On/Off, 0-10V
LL2023.862-US-T4-500-730	[T4] Type IV - 117x64°	6210 lm	48 W	3000 K CRI 70	On/Off, 0-10V

LL2023.862-US-T4-500-740	[T4] Type IV - 117x64°	6565 lm	48 W	4000 K CRI 70	On/Off, 0-10V
LL2023.862-US-T4-500-830	[T4] Type IV - 117x64°	5605 lm	48 W	3000 K CRI 80	On/Off, 0-10V
LL2023.862-US-T4-700-730	[T4] Type IV - 117x64°	8005 lm	67 W	3000 K CRI 70	On/Off, 0-10V
LL2023.862-US-T4-700-740	[T4] Type IV - 117x64°	8705 lm	67 W	4000 K CRI 70	On/Off, 0-10V
LL2023.862-US-T4-700-830	[T4] Type IV - 117x64°	7255 lm	67 W	3000 K CRI 80	On/Off, 0-10V
LL2023.862-US-T5-350-730	[T5] Type V - 117°	4400 lm	34 W	3000 K CRI 70	On/Off, 0-10V
LL2023.862-US-T5-350-740	[T5] Type V - 117°	4690 lm	34 W	4000 K CRI 70	On/Off, 0-10V
LL2023.862-US-T5-350-830	[T5] Type V - 117°	4115 lm	34 W	3000 K CRI 80	On/Off, 0-10V
LL2023.862-US-T5-500-730	[T5] Type V - 117°	6540 lm	48 W	3000 K CRI 70	On/Off, 0-10V
LL2023.862-US-T5-500-740	[T5] Type V - 117°	6920 lm	48 W	4000 K CRI 70	On/Off, 0-10V
LL2023.862-US-T5-500-830	[T5] Type V - 117°	5910 lm	48 W	3000 K CRI 80	On/Off, 0-10V
LL2023.862-US-T5-700-730	[T5] Type V - 117°	8435 lm	67 W	3000 K CRI 70	On/Off, 0-10V
LL2023.862-US-T5-700-740	[T5] Type V - 117°	8940 lm	67 W	4000 K CRI 70	On/Off, 0-10V
LL2023.862-US-T5-700-830	[T5] Type V - 117°	7645 lm	67 W	3000 K CRI 80	On/Off, 0-10V
LL2023.862-US-P4-350-730	[P4] Pedestrian crosswalk distribution - 20x78°	4400 lm	34 W	3000 K CRI 70	On/Off, 0-10V
LL2023.862-US-P4-350-740	[P4] Pedestrian crosswalk distribution - 20x78°	4690 lm	34 W	4000 K CRI 70	On/Off, 0-10V
LL2023.862-US-P4-350-830	[P4] Pedestrian crosswalk distribution - 20x78°	4115 lm	34 W	3000 K CRI 80	On/Off, 0-10V
LL2023.862-US-P4-500-730	[P4] Pedestrian crosswalk distribution - 20x78°	6455 lm	48 W	3000 K CRI 70	On/Off, 0-10V
LL2023.862-US-P4-500-740	[P4] Pedestrian crosswalk distribution - 20x78°	6830 lm	48 W	4000 K CRI 70	On/Off, 0-10V
LL2023.862-US-P4-500-830	[P4] Pedestrian crosswalk distribution - 20x78°	5830 lm	48 W	3000 K CRI 80	On/Off, 0-10V
LL2023.862-US-P4-700-730	[P4] Pedestrian crosswalk distribution - 20x78°	8325 lm	67 W	3000 K CRI 70	On/Off, 0-10V
LL2023.862-US-P4-700-740	[P4] Pedestrian crosswalk distribution - 20x78°	9025 lm	67 W	4000 K CRI 70	On/Off, 0-10V
LL2023.862-US-P4-700-830	[P4] Pedestrian crosswalk distribution - 20x78°	7545 lm	67 W	3000 K CRI 80	On/Off, 0-10V