

D-LIGHT AFX 1 Module

LL2023.861-US

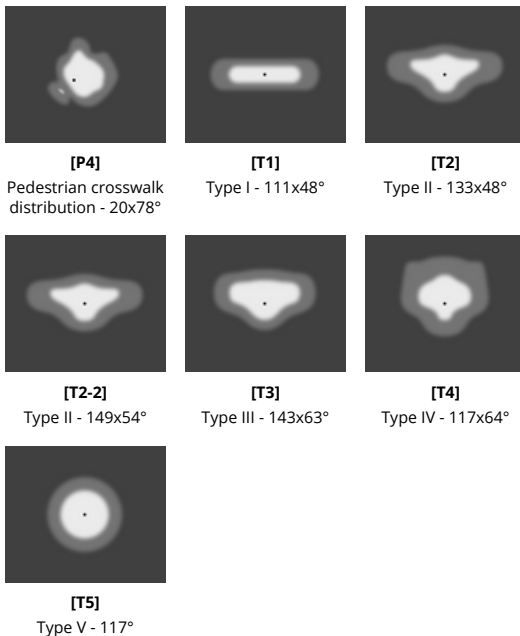
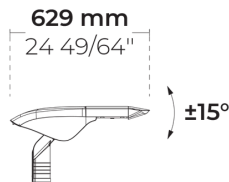

Configurations

Light distribution	[P4] 20x78°, [T1] 111x48°, [T2] 133x48°, [T2-2] 149x54°, [T3] 143x63°, [T4] 117x64°, [T5] 117°
Delivered lumens flux	1975 - 4540 lm
Rated input power	18 - 35 W
Color temperature	3000 K CRI 70, 3000 K CRI 80, 4000 K CRI 70
BUG rating	B1-U0-G1, B1-U0-G0, B2-U0-G1, B0-U0-G0, B2-U0-G0
Lifetime L90 (hour)	>102, 000
Lifetime L80 (hour)	>102, 000

Options

Control	On/Off, 0-10V
Product colors	

Extras

External surge protection	10 kV
Connectivity	7 Pin NEMA socket
Luminaire body options	Double powder coating

Technical information

Mounting	Direct pole or side bracket mountable. Tenon: Ø2 1/4" x 4"
Tilt angle	+15°/-15°
Housing	Corrosion resistant, die-cast, marine grade aluminum housing
Finishing	Chromate conversion pretreatment followed by electrostatic powder coating
Fasteners	Stainless steel (AISI 304 / EN 1.4301 grade)
Gasket	EPDM gasket (Shore A 20-25)
Lens / Reflector	PMMA lens with high optical efficiency
Glass / Diffusor	Tempered safety glass
Impact protection	IK08
Ingress protection	IP66
Input voltage	120-277V 50/60Hz
Insulation class	Class I
Wind catching area (EPA)	0.69 ft²
Weight	13.42 lbs
LED module	High power LEDs on metal-core PCB
Driver	Internal LED driver
Driver surge protection	4/2 kV
Power factor	> 0.90
Through wiring	Single power cord entry
Operating temperature	-40...50°C
Power cord	20" of outdoor use rated flexible power cord
Packing box dimensions	25 63/64" * 7 7/8" * 6 11/16"

Pole detail

Poles are supplied with flange plate. Flange cover and anchorage can be ordered separately. Embedded base is optional

Poles (To be ordered separately)

Round tapered aluminum poles with base plate

	Product code	Height	Diameter / Dimensions	Spigot / End diameter
	PAFK.D114	10', 13.1', 16.4'	Ø4 1/2"	Ø2 3/8", Ø3"
	PAFK.D122	13.1', 16.4', 19.7'	Ø5"	Ø2 3/8", Ø3"
	PAFK.D148	19.7', 23.0', 26.2'	Ø6"	Ø2 3/8", Ø3"
	PAFK.D165	19.7', 23.0', 26.2', 29.5'	Ø6 1/2"	Ø3 1/2", Ø3"
	PAFK.D180	26.2', 29.5', 32.8'	Ø7"	Ø3 1/2", Ø3"
	PAFK.D200	32.8', 36.1', 39.4'	Ø7 7/8"	Ø3 1/2", Ø3"

Round tapered aluminum poles (direct burial)

	Product code	Height	Diameter / Dimensions	Spigot / End diameter
	PABK.D114	10', 13.1', 16.4'	Ø4 1/2"	Ø2 3/8", Ø3"
	PABK.D122	13.1', 16.4', 19.7', 23.0'	Ø5"	Ø2 3/8", Ø3"
	PABK.D148	19.7', 23.0', 26.2'	Ø6"	Ø2 3/8", Ø3"
	PABK.D165	19.7', 23.0', 26.2', 29.5'	Ø6 1/2"	Ø3 1/2", Ø3"
	PABK.D180	26.2', 29.5', 32.8'	Ø7"	Ø3 1/2", Ø3"
	PABK.D200	32.8', 36.1', 39.4'	Ø7 7/8"	Ø3 1/2", Ø3"

Round cylindrical aluminum poles with base plate

	Product code	Height	Diameter / Dimensions	Spigot / End diameter
	PAFC.D114	10', 13.1', 16.4'	Ø4 1/2"	Ø4 1/2"
	PAFC.D122	10', 13.1', 16.4', 19.7'	Ø5"	Ø4 51/64"
	PAFC.D148	19.7', 23.0', 26.2'	Ø6"	Ø5 7/8"
	PAFC.D165	19.7', 23.0', 26.2', 29.5'	Ø6 1/2"	Ø6 1/2"

Accessories (To be ordered separately)

Mounting accessories

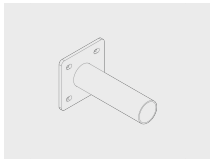



Wall mounting bracket

B6A.03.03.01001.0220

Project name		Type		Quantity	
Date		Note			

LL2023.861-US- _ _ _ _ _

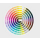
Light distribution	Rated input power	Color temperature	Control	Product colors
[P4] Pedestrian crosswalk distribution - 20x78° [T1] Type I - 111x48° [T2] Type II - 133x48° [T2-2] Type II - 149x54° [T3] Type III - 143x63° [T4] Type IV - 117x64° [T5] Type V - 117°	[350] 18 W [500] 25 W [700] 35 W	[730] 3000 K CRI 70 [830] 3000 K CRI 80 [740] 4000 K CRI 70	[ONOFF] On/Off [0-10V] 0-10V	[HM3]  Anthracite gray [HM4]  Light gray [CC]  Custom color (Please specify RAL code)
Extras	Accessories (To be ordered separately)			
External surge protection	Mounting accessories			
[SP10] 10 kV	[B6A.03.03.01001.0220] Wall mounting bracket			
Connectivity				
[NM7] 7 Pin NEMA socket				
Luminaire body options				
[DPC] Double powder coating				

Configuration code	Light distribution	Delivered lumens flux	Rated input power	Color temperature	Control
LL2023.861-US-T1-350-730	[T1] Type I - 111x48°	2265 lm	18 W	3000 K CRI 70	On/Off, 0-10V
LL2023.861-US-T1-350-740	[T1] Type I - 111x48°	2415 lm	18 W	4000 K CRI 70	On/Off, 0-10V
LL2023.861-US-T1-350-830	[T1] Type I - 111x48°	2115 lm	18 W	3000 K CRI 80	On/Off, 0-10V
LL2023.861-US-T1-500-730	[T1] Type I - 111x48°	3205 lm	25 W	3000 K CRI 70	On/Off, 0-10V
LL2023.861-US-T1-500-740	[T1] Type I - 111x48°	3390 lm	25 W	4000 K CRI 70	On/Off, 0-10V
LL2023.861-US-T1-500-830	[T1] Type I - 111x48°	2895 lm	25 W	3000 K CRI 80	On/Off, 0-10V
LL2023.861-US-T1-700-730	[T1] Type I - 111x48°	4135 lm	35 W	3000 K CRI 70	On/Off, 0-10V
LL2023.861-US-T1-700-740	[T1] Type I - 111x48°	4445 lm	35 W	4000 K CRI 70	On/Off, 0-10V
LL2023.861-US-T1-700-830	[T1] Type I - 111x48°	3750 lm	35 W	3000 K CRI 80	On/Off, 0-10V
LL2023.861-US-T2-350-730	[T2] Type II - 133x48°	2115 lm	18 W	3000 K CRI 70	On/Off, 0-10V
LL2023.861-US-T2-350-740	[T2] Type II - 133x48°	2255 lm	18 W	4000 K CRI 70	On/Off, 0-10V
LL2023.861-US-T2-350-830	[T2] Type II - 133x48°	1975 lm	18 W	3000 K CRI 80	On/Off, 0-10V
LL2023.861-US-T2-500-730	[T2] Type II - 133x48°	3250 lm	25 W	3000 K CRI 70	On/Off, 0-10V
LL2023.861-US-T2-500-740	[T2] Type II - 133x48°	3440 lm	25 W	4000 K CRI 70	On/Off, 0-10V
LL2023.861-US-T2-500-830	[T2] Type II - 133x48°	2935 lm	25 W	3000 K CRI 80	On/Off, 0-10V
LL2023.861-US-T2-700-730	[T2] Type II - 133x48°	4045 lm	35 W	3000 K CRI 70	On/Off, 0-10V
LL2023.861-US-T2-700-740	[T2] Type II - 133x48°	4510 lm	35 W	4000 K CRI 70	On/Off, 0-10V
LL2023.861-US-T2-700-830	[T2] Type II - 133x48°	3800 lm	35 W	3000 K CRI 80	On/Off, 0-10V
LL2023.861-US-T2-2-350-730	[T2] Type II - 149x54°	2150 lm	18 W	3000 K CRI 70	On/Off, 0-10V
LL2023.861-US-T2-2-350-740	[T2] Type II - 149x54°	2290 lm	18 W	4000 K CRI 70	On/Off, 0-10V
LL2023.861-US-T2-2-350-830	[T2] Type II - 149x54°	2010 lm	18 W	3000 K CRI 80	On/Off, 0-10V
LL2023.861-US-T2-2-500-730	[T2] Type II - 149x54°	3135 lm	25 W	3000 K CRI 70	On/Off, 0-10V
LL2023.861-US-T2-2-500-740	[T2] Type II - 149x54°	3320 lm	25 W	4000 K CRI 70	On/Off, 0-10V
LL2023.861-US-T2-2-500-830	[T2] Type II - 149x54°	2830 lm	25 W	3000 K CRI 80	On/Off, 0-10V
LL2023.861-US-T2-2-700-730	[T2] Type II - 149x54°	4190 lm	35 W	3000 K CRI 70	On/Off, 0-10V
LL2023.861-US-T2-2-700-740	[T2] Type II - 149x54°	4370 lm	35 W	4000 K CRI 70	On/Off, 0-10V
LL2023.861-US-T2-2-700-830	[T2] Type II - 149x54°	3665 lm	35 W	3000 K CRI 80	On/Off, 0-10V
LL2023.861-US-T3-350-730	[T3] Type III - 143x63°	2025 lm	18 W	3000 K CRI 70	On/Off, 0-10V
LL2023.861-US-T3-350-740	[T3] Type III - 143x63°	2155 lm	18 W	4000 K CRI 70	On/Off, 0-10V
LL2023.861-US-T3-350-830	[T3] Type III - 143x63°	1980 lm	18 W	3000 K CRI 80	On/Off, 0-10V
LL2023.861-US-T3-500-730	[T3] Type III - 143x63°	2985 lm	25 W	3000 K CRI 70	On/Off, 0-10V
LL2023.861-US-T3-500-740	[T3] Type III - 143x63°	3150 lm	25 W	4000 K CRI 70	On/Off, 0-10V
LL2023.861-US-T3-500-830	[T3] Type III - 143x63°	2695 lm	25 W	3000 K CRI 80	On/Off, 0-10V
LL2023.861-US-T3-700-730	[T3] Type III - 143x63°	3850 lm	35 W	3000 K CRI 70	On/Off, 0-10V
LL2023.861-US-T3-700-740	[T3] Type III - 143x63°	4140 lm	35 W	4000 K CRI 70	On/Off, 0-10V
LL2023.861-US-T3-700-830	[T3] Type III - 143x63°	3490 lm	35 W	3000 K CRI 80	On/Off, 0-10V
LL2023.861-US-T4-350-730	[T4] Type IV - 117x64°	2120 lm	18 W	3000 K CRI 70	On/Off, 0-10V
LL2023.861-US-T4-350-740	[T4] Type IV - 117x64°	2260 lm	18 W	4000 K CRI 70	On/Off, 0-10V
LL2023.861-US-T4-350-830	[T4] Type IV - 117x64°	1980 lm	18 W	3000 K CRI 80	On/Off, 0-10V
LL2023.861-US-T4-500-730	[T4] Type IV - 117x64°	3105 lm	25 W	3000 K CRI 70	On/Off, 0-10V

LL2023.861-US-T4-500-740	[T4] Type IV - 117x64°	3275 lm	25 W	4000 K CRI 70	On/Off, 0-10V
LL2023.861-US-T4-500-830	[T4] Type IV - 117x64°	2805 lm	25 W	3000 K CRI 80	On/Off, 0-10V
LL2023.861-US-T4-700-730	[T4] Type IV - 117x64°	4005 lm	35 W	3000 K CRI 70	On/Off, 0-10V
LL2023.861-US-T4-700-740	[T4] Type IV - 117x64°	4310 lm	35 W	4000 K CRI 70	On/Off, 0-10V
LL2023.861-US-T4-700-830	[T4] Type IV - 117x64°	3630 lm	35 W	3000 K CRI 80	On/Off, 0-10V
LL2023.861-US-T5-350-730	[T5] Type V - 117°	2200 lm	18 W	3000 K CRI 70	On/Off, 0-10V
LL2023.861-US-T5-350-740	[T5] Type V - 117°	2345 lm	18 W	4000 K CRI 70	On/Off, 0-10V
LL2023.861-US-T5-350-830	[T5] Type V - 117°	2055 lm	18 W	3000 K CRI 80	On/Off, 0-10V
LL2023.861-US-T5-500-730	[T5] Type V - 117°	3270 lm	25 W	3000 K CRI 70	On/Off, 0-10V
LL2023.861-US-T5-500-740	[T5] Type V - 117°	3445 lm	25 W	4000 K CRI 70	On/Off, 0-10V
LL2023.861-US-T5-500-830	[T5] Type V - 117°	2955 lm	25 W	3000 K CRI 80	On/Off, 0-10V
LL2023.861-US-T5-700-730	[T5] Type V - 117°	4220 lm	35 W	3000 K CRI 70	On/Off, 0-10V
LL2023.861-US-T5-700-740	[T5] Type V - 117°	4540 lm	35 W	4000 K CRI 70	On/Off, 0-10V
LL2023.861-US-T5-700-830	[T5] Type V - 117°	3820 lm	35 W	3000 K CRI 80	On/Off, 0-10V
LL2023.861-US-P4-350-730	[P4] Pedestrian crosswalk distribution - 20x78°	2200 lm	18 W	3000 K CRI 70	On/Off, 0-10V
LL2023.861-US-P4-350-740	[P4] Pedestrian crosswalk distribution - 20x78°	2345 lm	18 W	4000 K CRI 70	On/Off, 0-10V
LL2023.861-US-P4-350-830	[P4] Pedestrian crosswalk distribution - 20x78°	2055 lm	18 W	3000 K CRI 80	On/Off, 0-10V
LL2023.861-US-P4-500-730	[P4] Pedestrian crosswalk distribution - 20x78°	3225 lm	25 W	3000 K CRI 70	On/Off, 0-10V
LL2023.861-US-P4-500-740	[P4] Pedestrian crosswalk distribution - 20x78°	3400 lm	25 W	4000 K CRI 70	On/Off, 0-10V
LL2023.861-US-P4-500-830	[P4] Pedestrian crosswalk distribution - 20x78°	2915 lm	25 W	3000 K CRI 80	On/Off, 0-10V
LL2023.861-US-P4-700-730	[P4] Pedestrian crosswalk distribution - 20x78°	4160 lm	35 W	3000 K CRI 70	On/Off, 0-10V
LL2023.861-US-P4-700-740	[P4] Pedestrian crosswalk distribution - 20x78°	4480 lm	35 W	4000 K CRI 70	On/Off, 0-10V
LL2023.861-US-P4-700-830	[P4] Pedestrian crosswalk distribution - 20x78°	3770 lm	35 W	3000 K CRI 80	On/Off, 0-10V