

# D-LIGHT ML 3 Module

LL2023.673-US

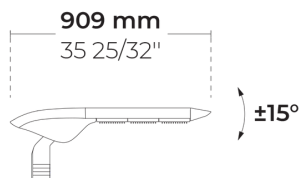

[T2]  
Type II - 130x85°

## Configurations

Light distribution	[T2] 130x85°
Delivered lumens flux	8837 - 10691 lm
Rated input power	101 W
Color temperature	3000 K CRI 70, 3000 K CRI 80, 4000 K CRI 70
BUG rating	B2-U0-G1, B2-U0-G2
Lifetime L90 (hour)	>60,000
Lifetime L80 (hour)	>60,000

## Options

Control	On/Off, 0-10V
Product colors	  

## Extras

External surge protection	10 kV
Connectivity	7 Pin NEMA socket
Luminaire body options	Double powder coating

## Technical information

Mounting	Direct pole or side bracket mountable. Tenon: Ø2 1/4" x 4"
Tilt angle	+15°/-15°
Housing	Corrosion resistant, die-cast, marine grade aluminum housing
Finishing	Chromate conversion pretreatment followed by electrostatic powder coating
Fasteners	Stainless steel (AISI 304 / EN 1.4301 grade)
Gasket	EPDM gasket (Shore A 20-25)
Lens / Reflector	High reflectance aluminium coating, multifaceted micro reflector
Glass / Diffusor	Bio-based, enriched with bisphenol A diffusor
Impact protection	IK08
Ingress protection	IP66
Input voltage	120-277V 50/60Hz
Insulation class	Class I
Wind catching area (EPA)	0.90 ft²
Weight	22.4 lbs
LED module	Multi-chip high power LEDs on metal-core PCB
Driver	Internal LED driver
Driver surge protection	6/4 kV
Power factor	> 0.98
Through wiring	Single power cord entry
Operating temperature	-40...50°C
Power cord	20" of outdoor use rated flexible power cord
Pole detail	Poles are supplied with flange plate. Flange cover and anchorage can be ordered separately. Embedded base is optional

## Poles (To be ordered separately)

### Round tapered aluminum poles with base plate

	Product code	Height	Diameter / Dimensions	Spigot / End diameter
	PAFK.D114	10', 13.1', 16.4'	Ø4 1/2"	Ø2 3/8", Ø3"
	PAFK.D122	13.1', 16.4', 19.7'	Ø5"	Ø2 3/8", Ø3"
	PAFK.D148	19.7', 23.0', 26.2'	Ø6"	Ø2 3/8", Ø3"
	PAFK.D165	19.7', 23.0', 26.2', 29.5'	Ø6 1/2"	Ø3 1/2", Ø3"
	PAFK.D180	26.2', 29.5', 32.8'	Ø7"	Ø3 1/2", Ø3"
	PAFK.D200	32.8', 36.1', 39.4'	Ø7 7/8"	Ø3 1/2", Ø3"

### Round tapered aluminum poles (direct burial)

	Product code	Height	Diameter / Dimensions	Spigot / End diameter
	PABK.D114	10', 13.1', 16.4'	Ø4 1/2"	Ø2 3/8", Ø3"
	PABK.D122	13.1', 16.4', 19.7', 23.0'	Ø5"	Ø2 3/8", Ø3"
	PABK.D148	19.7', 23.0', 26.2'	Ø6"	Ø2 3/8", Ø3"
	PABK.D165	19.7', 23.0', 26.2', 29.5'	Ø6 1/2"	Ø3 1/2", Ø3"
	PABK.D180	26.2', 29.5', 32.8'	Ø7"	Ø3 1/2", Ø3"
	PABK.D200	32.8', 36.1', 39.4'	Ø7 7/8"	Ø3 1/2", Ø3"

### Round cylindrical aluminum poles with base plate

	Product code	Height	Diameter / Dimensions	Spigot / End diameter
	PAFC.D114	10', 13.1', 16.4'	Ø4 1/2"	Ø4 1/2"
	PAFC.D122	10', 13.1', 16.4', 19.7'	Ø5"	Ø4 51/64"
	PAFC.D148	19.7', 23.0', 26.2'	Ø6"	Ø5 7/8"
	PAFC.D165	19.7', 23.0', 26.2', 29.5'	Ø6 1/2"	Ø6 1/2"

## Accessories (To be ordered separately)

### Mounting accessories

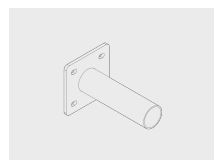



#### Wall mounting bracket

B6A.03.03.01001.0220

Project name				Type		Quantity	
Date		Note					

**LL2023.673-US-**\_\_\_\_-\_\_\_\_-\_\_\_\_-\_\_\_\_-\_\_\_\_-\_\_\_\_-\_\_\_\_-\_\_\_\_

Light distribution	Rated input power	Color temperature	Control	Product colors
<b>[T2]</b> Type II - 130x85°	<b>[700]</b> 101 W	<b>[730]</b> 3000 K CRI 70  <b>[830]</b> 3000 K CRI 80  <b>[740]</b> 4000 K CRI 70	<b>[ONOFF]</b> On/Off  <b>[0-10V]</b> 0-10V	<b>[HM3]</b>  Anthracite gray  <b>[HM4]</b>  Light gray  <b>[CC]</b>  Custom color (Please specify RAL code)
<b>Extras</b>	<b>Accessories (<i>To be ordered separately</i>)</b>			
<b>External surge protection</b>	<b>Mounting accessories</b>			
<b>[SP10]</b> 10 kV	<b>[B6A.03.03.01001.0220]</b> Wall mounting bracket			
<b>Connectivity</b>				
<b>[NM7]</b> 7 Pin NEMA socket				
<b>Luminaire body options</b>				
<b>[DPC]</b> Double powder coating				

Configuration code	Light distribution	Delivered lumens flux	Rated input power	Color temperature	Control
LL2023.673-US-T2-700-730	[T2] Type II - 130x85°	10691 lm	101 W	3000 K CRI 70	On/Off, 0-10V
LL2023.673-US-T2-700-740	[T2] Type II - 130x85°	10346 lm	101 W	4000 K CRI 70	On/Off, 0-10V
LL2023.673-US-T2-700-830	[T2] Type II - 130x85°	8837 lm	101 W	3000 K CRI 80	On/Off, 0-10V