

D-LIGHT ML 1 Module

LL2023.671-US

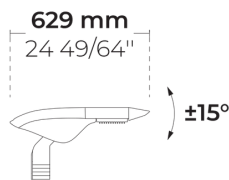

[T2]
Type II - 130x85°

Configurations

Light distribution	[T2] 130x85°
Delivered lumens flux	2945 - 3563 lm
Rated input power	35 W
Color temperature	3000 K CRI 70, 3000 K CRI 80, 4000 K CRI 70
BUG rating	B1-U0-G1
Lifetime L90 (hour)	>60,000
Lifetime L80 (hour)	>60,000

Options

Control	On/Off, 0-10V
Product colors	

Extras

External surge protection	10 kV
Connectivity	7 Pin NEMA socket
Luminaire body options	Double powder coating

Technical information

Mounting	Direct pole or side bracket mountable. Tenon: Ø2 1/4" x 4" +15°/-15°
Tilt angle	+15°/-15°
Housing	Corrosion resistant, die-cast, marine grade aluminum housing
Finishing	Chromate conversion pretreatment followed by electrostatic powder coating
Fasteners	Stainless steel (AISI 304 / EN 1.4301 grade)
Gasket	EPDM gasket (Shore A 20-25)
Lens / Reflector	High reflectance aluminium coating, multifaceted micro reflector
Glass / Diffusor	Bio-based, enriched with bisphenol A diffusor
Impact protection	IK08
Ingress protection	IP66
Input voltage	120-277V 50/60Hz
Insulation class	Class I
Wind catching area (EPA)	0.71 ft²
Weight	15.6 lbs
LED module	Multi-chip high power LEDs on metal-core PCB
Driver	Internal LED driver
Driver surge protection	10/6 kV
Power factor	> 0.95
Through wiring	Single power cord entry
Operating temperature	-40...50°C
Power cord	20" of outdoor use rated flexible power cord
Pole detail	Poles are supplied with flange plate. Flange cover and anchorage can be ordered separately. Embedded base is optional

Poles (To be ordered separately)

Round tapered aluminum poles with base plate

	Product code	Height	Diameter / Dimensions	Spigot / End diameter
	PAFK.D114	10', 13.1', 16.4'	Ø4 1/2"	Ø2 3/8", Ø3"
	PAFK.D122	13.1', 16.4', 19.7'	Ø5"	Ø2 3/8", Ø3"
	PAFK.D148	19.7', 23.0', 26.2'	Ø6"	Ø2 3/8", Ø3"
	PAFK.D165	19.7', 23.0', 26.2', 29.5'	Ø6 1/2"	Ø3 1/2", Ø3"
	PAFK.D180	26.2', 29.5', 32.8'	Ø7"	Ø3 1/2", Ø3"
	PAFK.D200	32.8', 36.1', 39.4'	Ø7 7/8"	Ø3 1/2", Ø3"

Round tapered aluminum poles (direct burial)

	Product code	Height	Diameter / Dimensions	Spigot / End diameter
	PABK.D114	10', 13.1', 16.4'	Ø4 1/2"	Ø2 3/8", Ø3"
	PABK.D122	13.1', 16.4', 19.7', 23.0'	Ø5"	Ø2 3/8", Ø3"
	PABK.D148	19.7', 23.0', 26.2'	Ø6"	Ø2 3/8", Ø3"
	PABK.D165	19.7', 23.0', 26.2', 29.5'	Ø6 1/2"	Ø3 1/2", Ø3"
	PABK.D180	26.2', 29.5', 32.8'	Ø7"	Ø3 1/2", Ø3"
	PABK.D200	32.8', 36.1', 39.4'	Ø7 7/8"	Ø3 1/2", Ø3"

Round cylindrical aluminum poles with base plate

	Product code	Height	Diameter / Dimensions	Spigot / End diameter
	PAFC.D114	10', 13.1', 16.4'	Ø4 1/2"	Ø4 1/2"
	PAFC.D122	10', 13.1', 16.4', 19.7'	Ø5"	Ø4 51/64"
	PAFC.D148	19.7', 23.0', 26.2'	Ø6"	Ø5 7/8"
	PAFC.D165	19.7', 23.0', 26.2', 29.5'	Ø6 1/2"	Ø6 1/2"

Accessories (To be ordered separately)

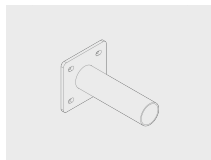

Mounting accessories



Wall mounting bracket

B6A.03.03.01001.0220

Project name		Type		Quantity	
Date		Note			
LL2023.671-US- _ _ _ _ _					

Light distribution	Rated input power	Color temperature	Control	Product colors
[T2] Type II - 130x85°	[700] 35 W	[730] 3000 K CRI 70 [830] 3000 K CRI 80 [740] 4000 K CRI 70	[ONOFF] On/Off [0-10V] 0-10V	[HM3]  Anthracite gray [HM4]  Light gray [CC]  Custom color (Please specify RAL code)

Extras	Accessories (<i>To be ordered separately</i>)
External surge protection	Mounting accessories
[SP10] 10 kV	[B6A.03.03.01001.0220] Wall mounting bracket
Connectivity	
[NM7] 7 Pin NEMA socket	
Luminaire body options	
[DPC] Double powder coating	

Configuration code	Light distribution	Delivered lumens flux	Rated input power	Color temperature	Control
LL2023.671-US-T2-700-730	[T2] Type II - 130x85°	3563 lm	35 W	3000 K CRI 70	On/Off, 0-10V
LL2023.671-US-T2-700-740	[T2] Type II - 130x85°	3448 lm	35 W	4000 K CRI 70	On/Off, 0-10V
LL2023.671-US-T2-700-830	[T2] Type II - 130x85°	2945 lm	35 W	3000 K CRI 80	On/Off, 0-10V