

REGIO V2 R HP 2 Module

LF8038.562-EN

CE UK CA IK08 IP66 

heper⁺



366 mm

14 13/32"

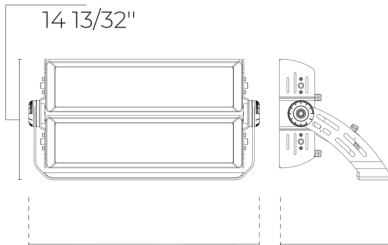

744 mm
29 19/64"

344 mm
13 35/64"



[EL]

Elliptical - 20x30°



[EL-2]

Elliptical - 35x85°

Variants

Light distribution	[EL] 20x30°, [EL-2] 35x85°
Delivered lumens flux	44607 - 211558 lm
Rated input power	380 - 1780 W
Colour temperature	2700 K CRI 80, 3000 K CRI 80
Lifetime L90B50 (hour)	>52, 000
Lifetime L80B50 (hour)	>52, 000

Options

Product colours



Extras

Consult the factory

120-277V 50/60Hz

Technical information

Mounting	Surface mountable via a bracket
Tilt angle	+110°/-180°
Rotation angle	±6.5°
Housing	Corrosion resistant, die-cast, marine grade aluminum housing
Finishing	Chromate conversion pretreatment followed by electrostatic powder coating
Fasteners	Stainless steel (AISI 304 / EN 1.4301 grade)
Gasket	Silicone
Glass / Diffuser	Tempered safety glass
Impact protection	IK08
Ingress protection	IP66
Input voltage	220-240V 50/60Hz
Insulation class	Class I
Weight	20.2 kg
Driver	External LED driver
Driver surge protection	10/6 kV
Power factor	> 0.99
Through wiring	Single cable entry
Operating temperature	-40...50°C
Cable	1 m of flexible cable

HPR Pazarlama A.Ş.
Başkent OSB 22. Cd. No: 2, Malıköy, Temelli,
Sincan, 06909 Ankara, Turkey
+90 312 267 54 30
info@hepergroup.com

HEPER Europe GmbH
Ahornweg 5a, 58675
Hemer, Germany
+49 237 2901 2975
infoEU@hepergroup.com

We reserve the right to change specifications without prior written notice. Edition: 23.02.2024. For current version visit heperlighting.com. All flux (±%7 tolerance) and power values (±%10 tolerance) are derived following appropriate IES, CIE, and applicable standards.

Accessories (To be ordered separately)

Optical accessories

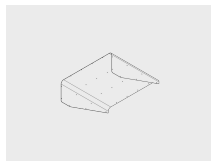



Visor for REGIO V2 2 Module

100139031

Project name		Type		Quantity	
Date		Note			

LF8038.562-EN-__-__-__-__-EN-C1-__-__

Light distribution	Rated input power	Colour temperature	Control	Product colours
[EL] Elliptical - 20x30°	[2100] 380 W	[827] 2700 K CRI 80		[HM3]  Anthracite grey
[EL-2] Elliptical - 35x85°	[2170] 780 W	[830] 3000 K CRI 80		[HM4]  Light grey
	[3265] 1180 W			[CC]  Custom colour (Please specify RAL code)
	[1453] 1780 W			
Extras	Accessories (<i>To be ordered separately</i>)			
Consult the factory	Optical accessories			
[UNI] 120-277V 50/60Hz	[100139031] Visor for REGIO V2 2 Module			

Variant code	Light distribution	Delivered lumens flux	Rated input power	Colour temperature	Control
LF8038.562-EN-SLFB-3386-830	[EL] Elliptical - 20x30°	84789 lm	780 W	2700 K CRI 80	DALI
LF8038.562-EN-SLFB-3386-957	[EL] Elliptical - 20x30°	211558 lm	1780 W	2700 K CRI 80	DALI
LF8038.562-EN-SLFB-3386-740	[EL-2] Elliptical - 35x85°	145588 lm	1180 W	2700 K CRI 80	DALI
LF8038.562-EN-SLFB-3386-827	[EL-2] Elliptical - 35x85°	44607 lm	380 W	2700 K CRI 80	DALI
LF8038.562-EN-SLFB-3386-840	[EL-2] Elliptical - 35x85°	48081 lm	380 W	3000 K CRI 80	DALI