

HEPER USA LLC

W227 N546 Westmound Drive Waukesha, 53186
Wisconsin, United States
+1 312 910 9740
infoUS@hepergroup.com

HANDRA Side - Ø48 mm (LH5005.595-US)

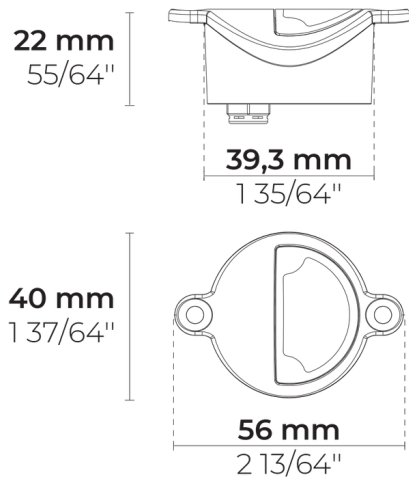

0.1 lbs

<https://heperlighting.com/us/lh5005.595-us/>

A Mm/Inch	B Mm/Inch	C Mm/Inch	D Mm/Inch	E Mm/Inch
40	23	46	48 60	M4
1 37/64	0 29/32	1 13/16	1 57/64 2 23/64	M4

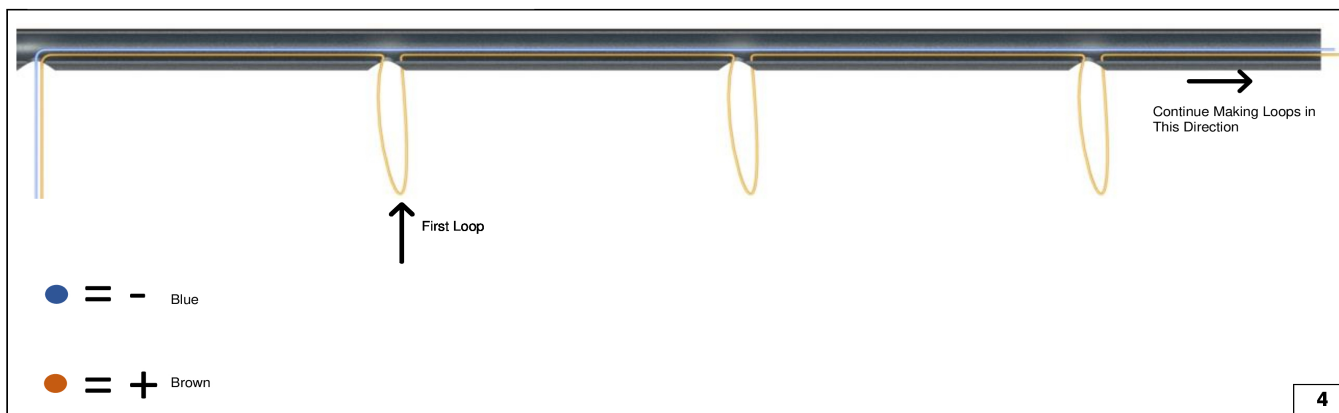
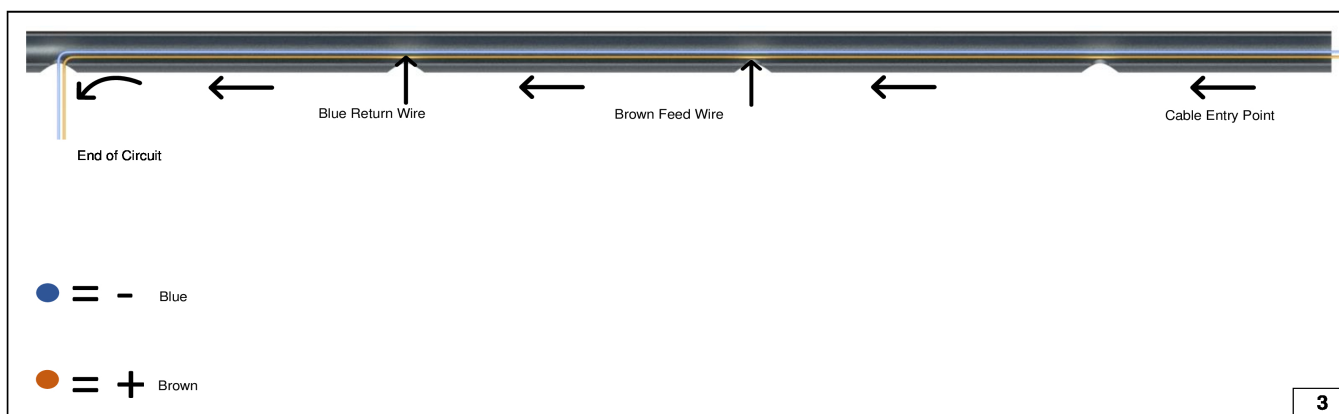
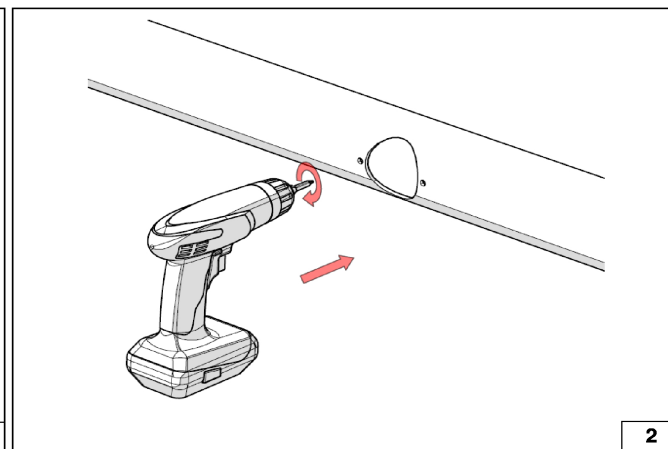

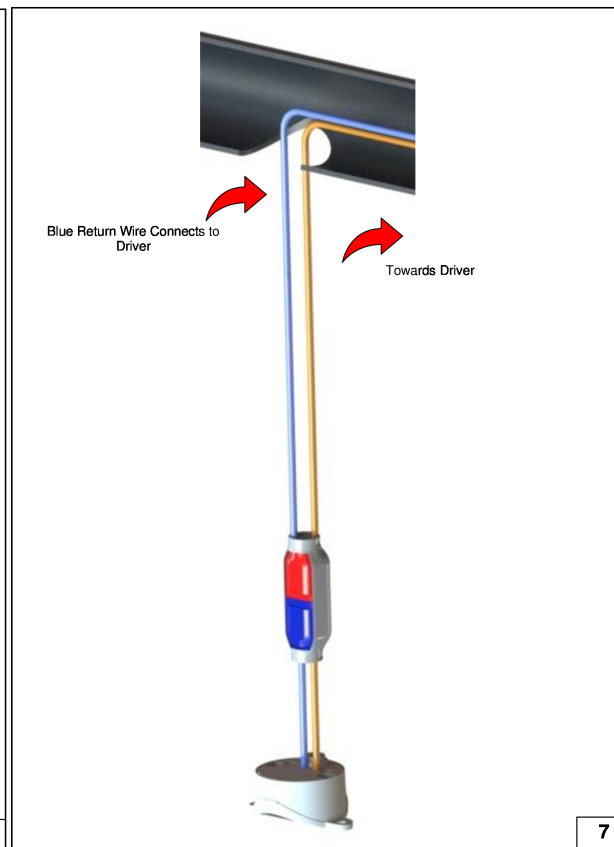
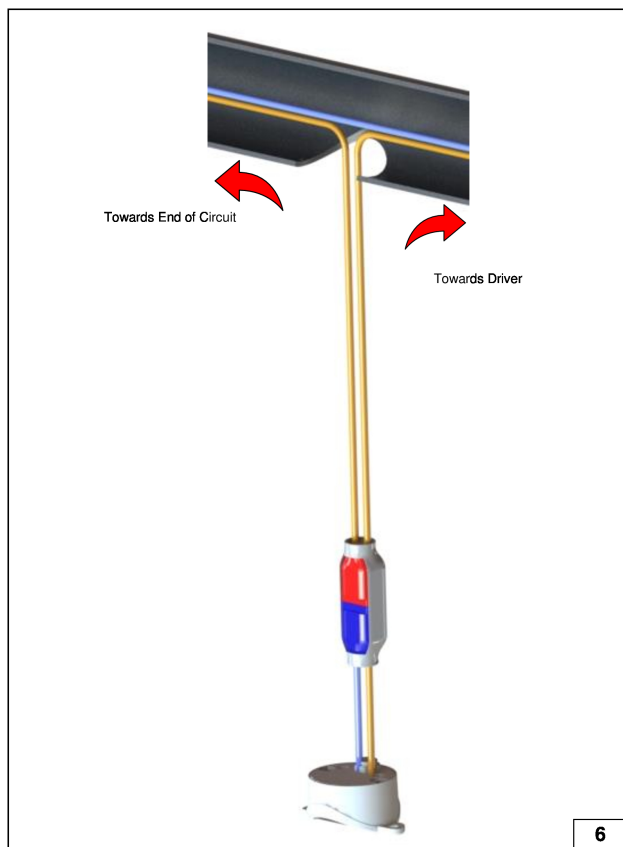
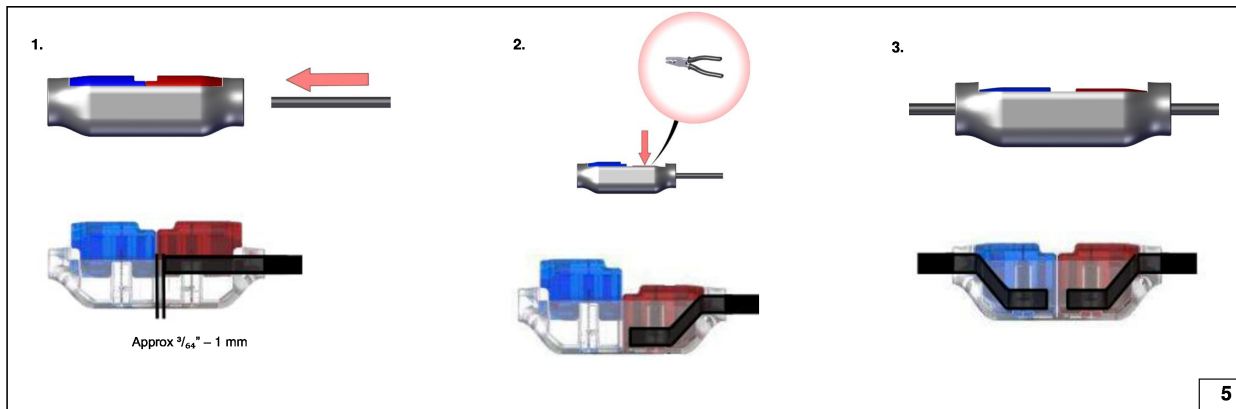

English (USA)

Safety



- The product must be installed in accordance with applicable NEC standards by a qualified electrician familiar with the installation of exterior lighting fixtures.



- The product must be operated under specified voltage at all times.



- Do not install if parts are damaged.



- Power must be disconnected while installing or servicing to avoid electrical shock.



- Failing to comply with warnings and installation steps in this document might void warranty.



- Do not touch the light source.

- Make sure that temperature of the product is at a safe level before touching.

- Do not allow cables to touch sharp edges of metal parts or other sharp objects to avoid damage or abrasion.



- Check all of the cable connections including grounding before powering the product.

- Check the proper grounding of the metal housing before powering the product.

- Only use the product for its intended purposes.



- Do not use accessories not approved or recommended by HEPER.



- Replace any broken/cracked protective surface with a new one

Installation

- The dimensions of the handrail on which the products will be mounted should be as shown in the visual.

- Open the holes on the handrail using the provided or appropriate hardware.

- To assemble the product, use a minimum IP 65 rated connector.

- As seen in the image, after the electrical connections of the products are completed, the products must be operated and observed for a minimum of 3 minutes by applying electricity to the driver boxes before they are mounted on the handrails.

- Secure the product with screws as shown on the visual.

- The light will be in the direction of the arrow.

- Cable connections may change according to the module quantity.

Please note that the max single line length is 70m and a 2x18 AWG power cable should be provided before installation.

Cleaning - Maintenance

- The product was designed and manufactured to operate for a long period of time. To ensure maximum lifespan of the product, regular (i.e. every six months) visual inspection and cleaning with a solvent-free cleaner using a soft cloth is recommended.

- Do not clean or service while the product is power connected.

Disposal



- In accordance with EU Directive WEEE (Waste Electrical and Electronic Equipment), luminaires must not be disposed of with other household waste. At the end of their life, luminaires must be taken to the appropriate local facility available for the disposal or recycling of electronic products.

Wiring Color Codes

- Ground - GREEN

- Line - BLACK

- Neutral - WHITE

- Dim(+) - RED/PURPLE

- Dim (-) - GRAY/ORANGE

Disclaimer

- HEPER reserve the right to make technical and design changes.